

# KELEN

## KE26 KELEN PP-RCT elbow 90° male/female 20

2711501

### Areas of application

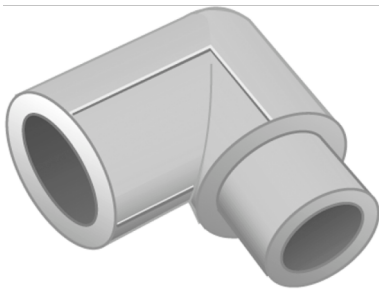

KELEN PP-RCT Polyfusion welding fitting for connecting pipes with fittings made of the same material (no reduction of internal diameter)

### Approvals:



KE KELIT GmbH

A 4020 Linz, Ignaz-Mayer-Straße 17, Austria, Europe

PHONE +43 (0) 50 779 E-MAIL [office@kekelit.com](mailto:office@kekelit.com)

[www.kekelit.com](http://www.kekelit.com)

# Specifications

## Article information

<b>port 1</b>	Kunststoffschweißmuffe
<b>port 2</b>	Kunststoffschweißende
<b>execution</b>	1-part
<b>design</b>	Winkel
<b>angle</b>	90 °

## Product information

<b>VPE1</b>	10,00 SA1
<b>VPE2</b>	150,00 KT1
<b>VPE3</b>	900,00 KT2
<b>VPE4</b>	14400,00 PAL
<b>weight</b>	0,020 KGM
<b>text</b>	KELEN PP-RCT elbow 90° male/female
<b>INTRNR</b>	39174000
<b>main material group</b>	KELEN
<b>material group</b>	KELEN plastic fittings
<b>code</b>	KE26

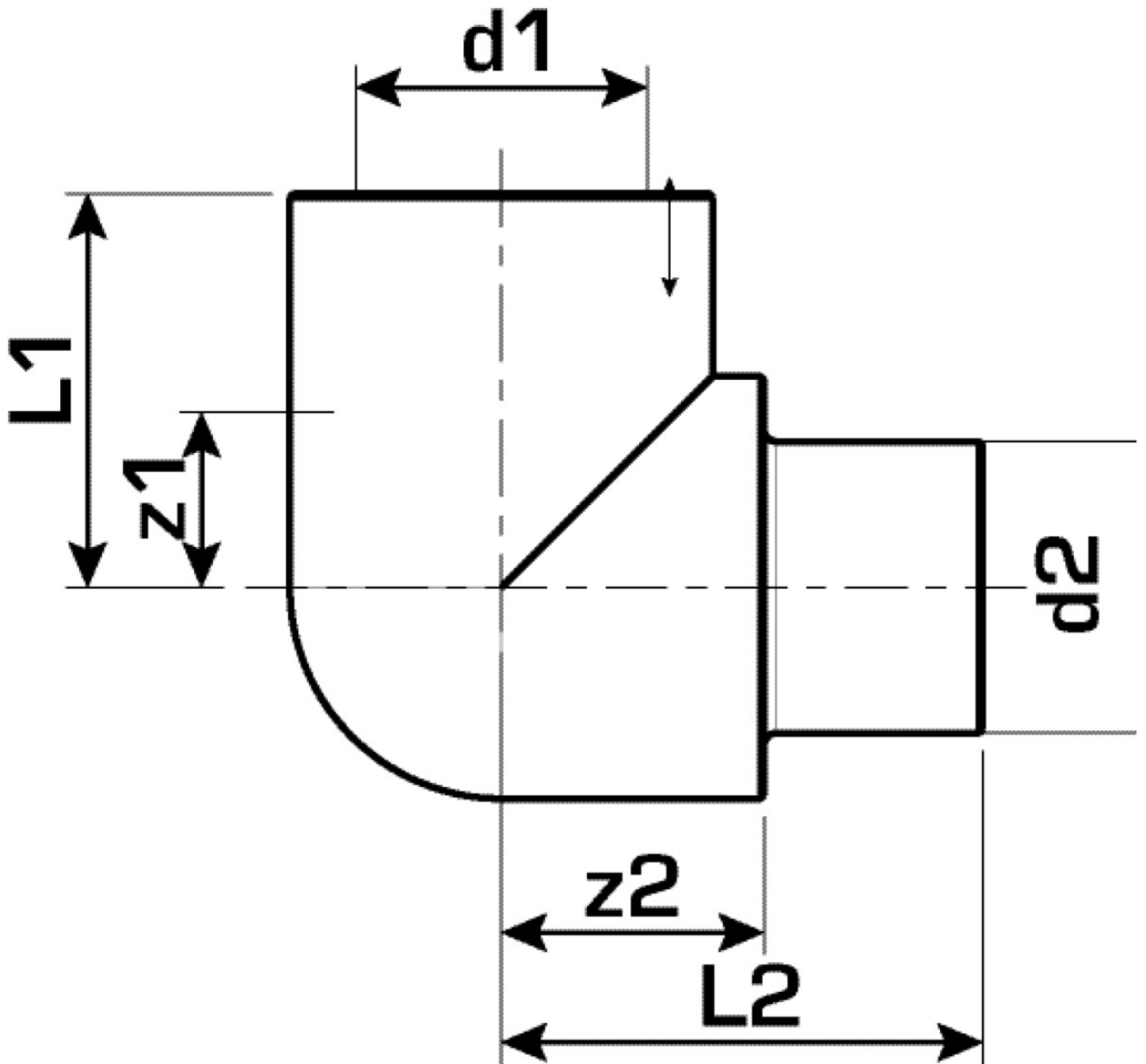

Art. No	label	d1 mm	d2 mm	L1 mm	L2 mm	z1 mm	z2 mm
2711501	20	20	20	26	48	11	33