

KELOX

KWW467 KELOX-WINDOWX-W adapter elbow 90° with female thread 20x1/2"

72416D02

Areas of application

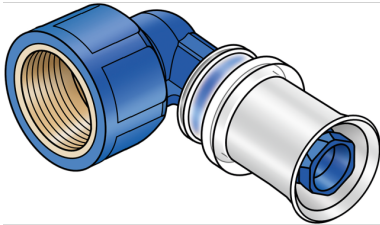

?Zeta value-optimised press-fit adapter bracket with female thread for sealing, made from PPSU, including support sleeves with O-rings and stainless steel press-fit sleeves "leak before pressed", audible leakage signal at air-pressure testing

DO NOT screw in threaded pipes and cast iron fittings!

DO NOT use liquid sealants!

Approvals:



Specifications

Article information

| | |
|---------------|---|
| port 1 | Pressmuffe |
| port 2 | Innengewinde zylindrisch BSPT-Rp (ISO 7-1 / EN 10226-1) |
| design | Winkel |
| angle | 90 ° |
| press contour | U |

Technical properties

| | |
|------------------------------------|--------|
| maximum working pressure at 20 ° C | 16 bar |
|------------------------------------|--------|

Product information

| | |
|---------------------|--|
| VPE1 | 10,00 SA1 |
| VPE2 | 30,00 KT1 |
| VPE3 | 2160,00 PAL |
| weight | 0,038 KGM |
| text | KELOX-WINDOWX-W adapter elbow 90° with female thread |
| INTRNR | 74122000 |
| main material group | KELOX |
| code | KWW467 |

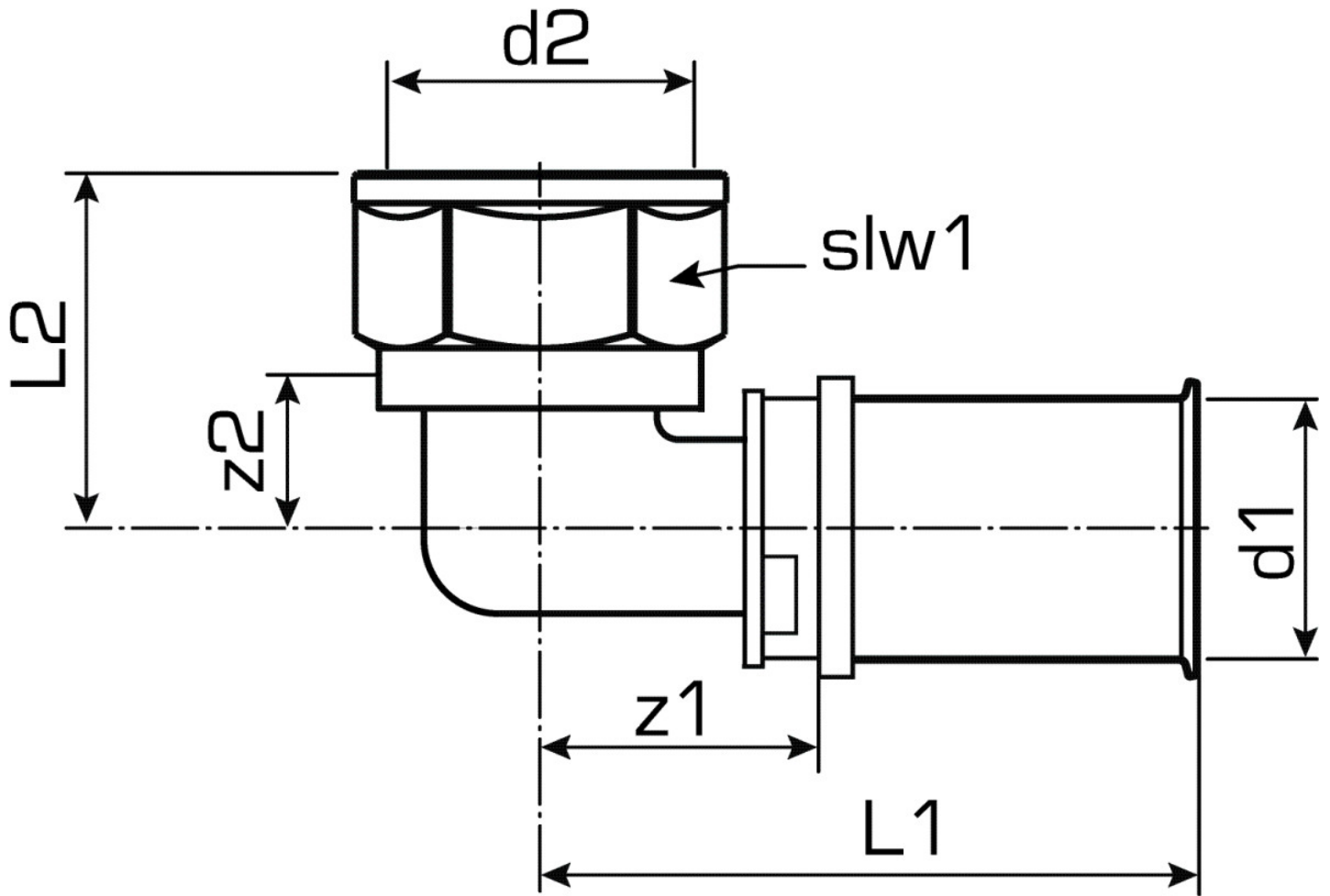

| Art. No | label | d2 | d1 mm | L1 mm | L2 mm | z1 mm | z2 mm |
|----------|---------|-----------|-------|-------|-------|-------|-------|
| 72416D02 | 20x1/2" | 1/2" (15) | 20 | 50 | 33 | 24 | 20 |