

STEEL FIX C-STAHl

CP424 STEELFIX carbon steel press-fit-elbow
30° male/female 54

54619HH0

Areas of application

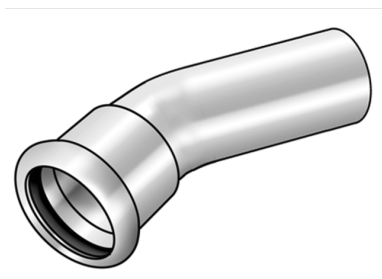

Press-elbow 30°, f/m, made of carbon steel coated with a zinc layer, incl. EPDM sealing components, d42-54 "leak before pressed"

Press contour: M

Specifications

Article information

port 1	Pressmuffe
port 2	Pressmuffe
execution	1-part
design	Winkel
angle	30 °
press contour	M

Technical properties

maximum working pressure at 20 ° C	16 bar
------------------------------------	--------

Product information

VPE1	2,00 SA1
VPE2	8,00 KT1
weight	0,320 KGM
text	STEELFIX carbon steel press-fit-elbow 30° male/female
INTRNR	73079980
main material group	STEELFIX
material group	C-STAHL pressfittings
code	CP424

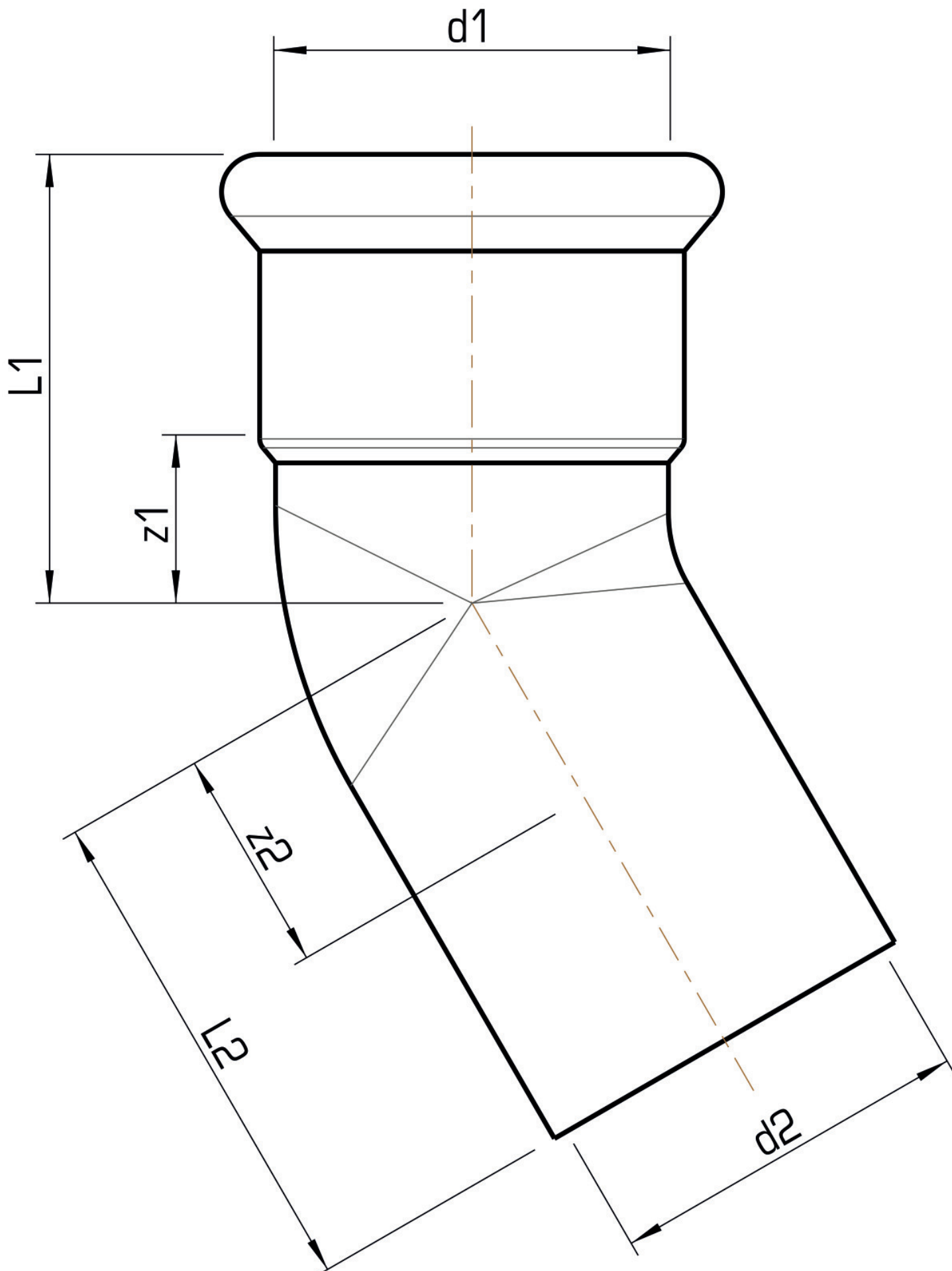

Art. No	label	d1 mm	d2 mm	L1 mm	L2 mm	z1 mm	z2 mm
54619HH0	54	54	54	62,5	58	27,5	23



KE KELIT GmbH

A 4020 Linz, Ignaz-Mayer-Straße 17, Austria, Europe

PHONE +43 (0) 50 779 **E-MAIL** office@kekelit.com

www.kekelit.com