

STEEL FIX C-STAHL

CP426 STEELFIX carbon steel press-fit-elbow
45° male/female 76,1

54621JJ0

Areas of application

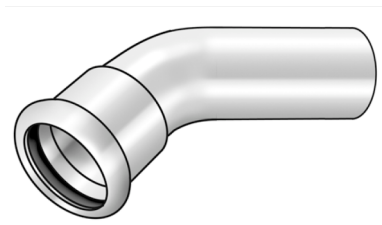

Press-elbow 45° made of carbon steel coated with a zinc layer, incl. EPDM sealing elements, d15-54
"leak before pressed"

Press contour: M

Specifications

Article information

| | |
|---------------|-----------------|
| port 1 | Pressmuffe |
| port 2 | Zapfen/Rohrende |
| execution | 1-part |
| design | Bogen |
| angle | 45 ° |
| press contour | M |

Technical properties

| | |
|------------------------------------|--------|
| maximum working pressure at 20 ° C | 16 bar |
|------------------------------------|--------|

Product information

| | |
|---------------------|---|
| VPE1 | 2,00 SA1 |
| VPE2 | 12,00 KT1 |
| weight | 1,401 KGM |
| text | STEELFIX carbon steel press-fit-elbow 45° male/female |
| INTRNR | 73079980 |
| main material group | STEELFIX |
| material group | C-STAHL pressfittings |
| code | CP426 |

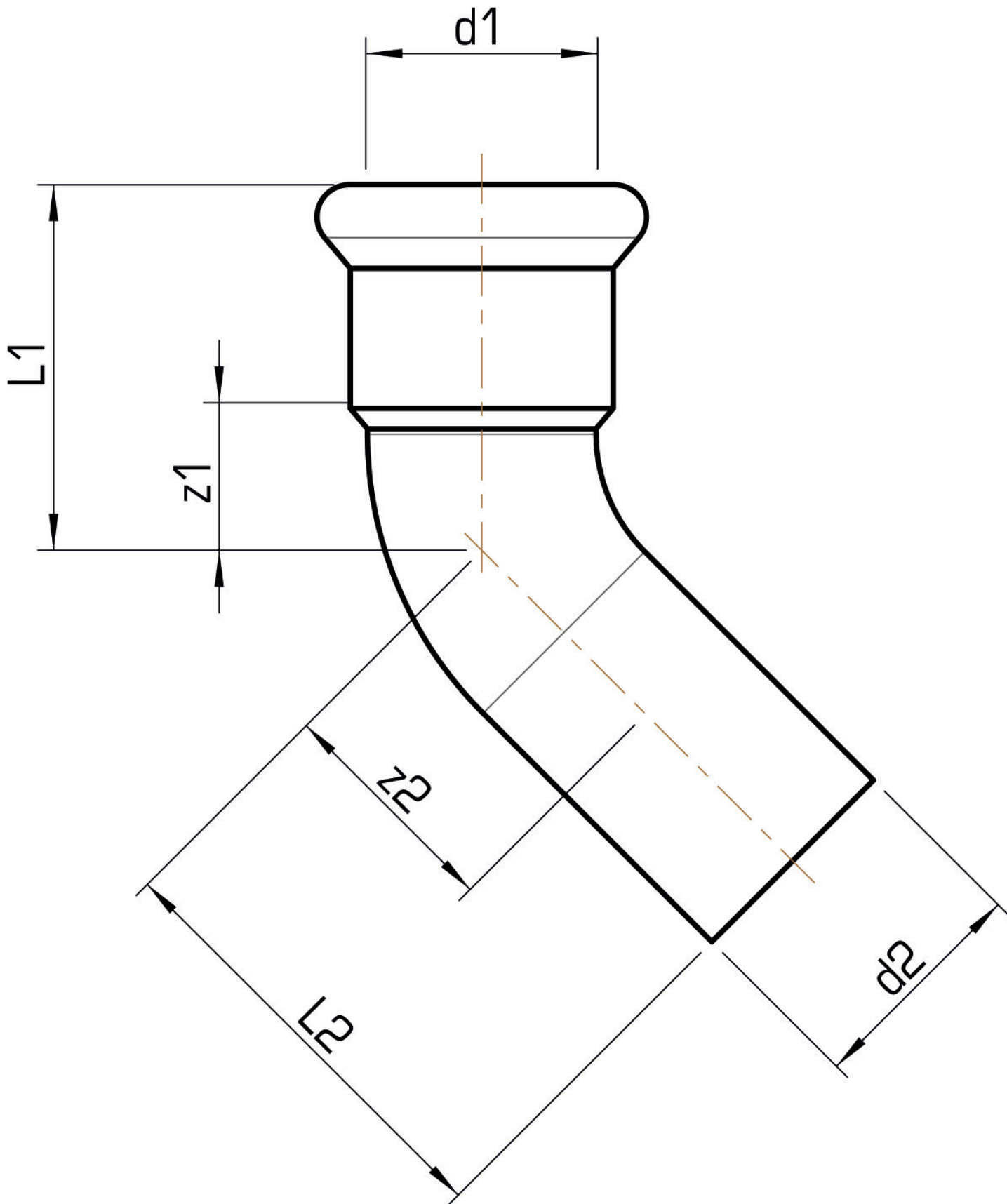

| Art. No | label | d1 mm | d2 mm | L1 mm | L2 mm | z1 mm | z2 mm |
|----------|-------|-------|-------|-------|-------|-------|-------|
| 54621JJ0 | 76,1 | 76,1 | 76,1 | 96 | 119 | 41 | 64 |



KE KELIT GmbH

A 4020 Linz, Ignaz-Mayer-Straße 17, Austria, Europe

PHONE +43 (0) 50 779 **E-MAIL** office@kekelit.com

www.kekelit.com