

STEEL FIX C-STAHl

CP447G C-Steel press-adaptor tee female - pipe end 28x1/2"

54745E02

Areas of application

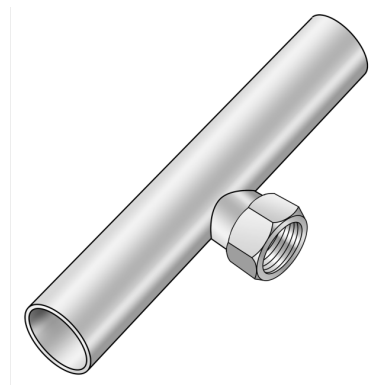

Press-fit tee as a pipe end with female-threaded branch made of carbon steel coated with a zinc layer
Total length: 88mm with branch 1/2" female thread in the middle

Specifications

Article information

port 1	Schiebeende
port 2	Innengewinde metrisch
port 3	Schiebeende
execution	T-Stück
angle	90 °
press contour	M

Technical properties

maximum working pressure at 20 ° C	16 bar
------------------------------------	--------

Product information

VPE1	4 SA1
VPE2	12 KT1
weight	0,31 KGM
text	C-Steel press-adaptor tee female - pipe end
INTRNR	73079980
main material group	STEELFIX
material group	C-STAHL pressfittings
code	CP447G

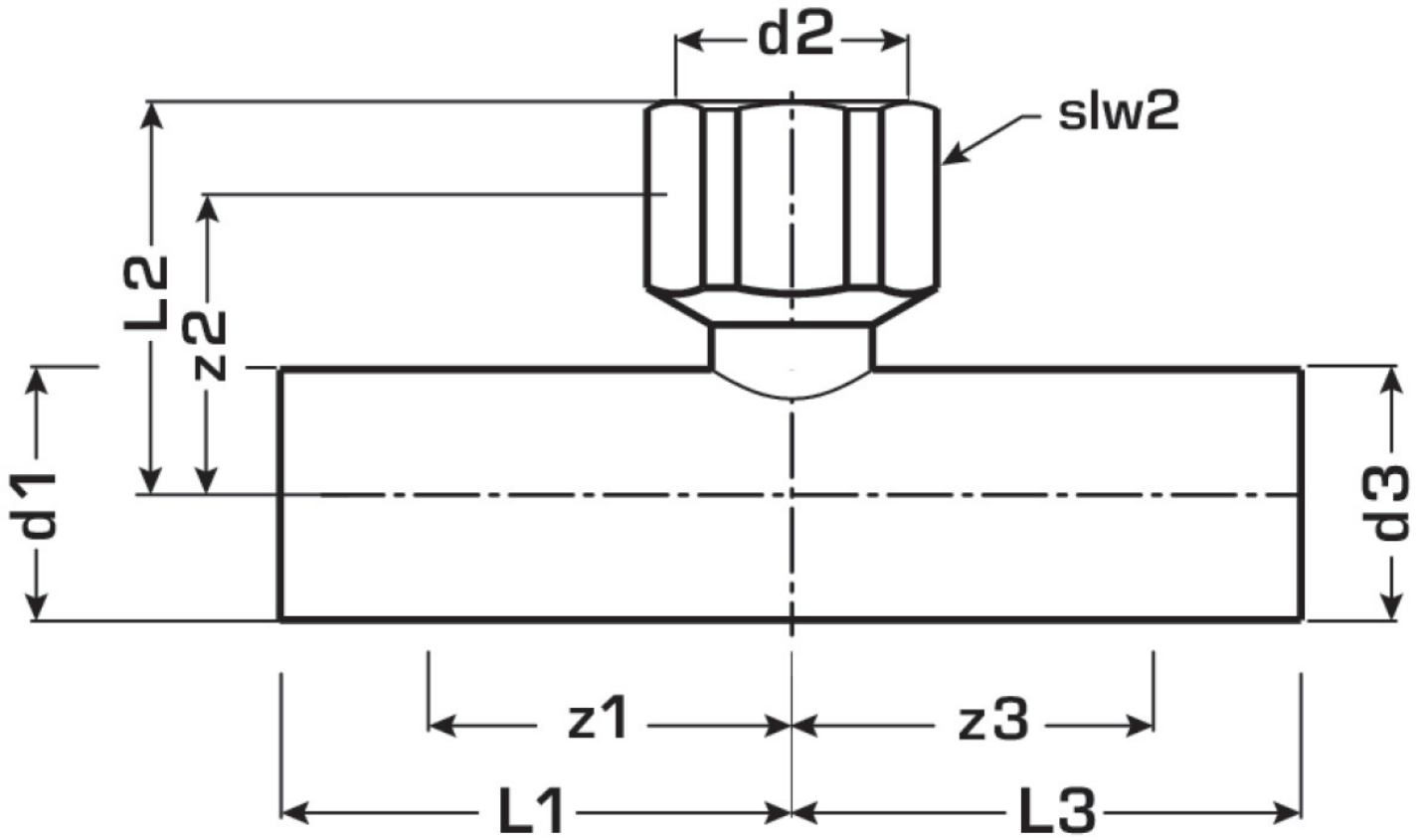

Art. No	label	d2	d1 mm	d3 mm	L1 mm	L2 mm	L3 mm	z1 mm	z2 mm	z3 mm	slw1 mm
54745E0	28x1/2" Zoll (15)	1/2	28	28	44	42	44	21	27	21	24