

STEEL FIX C-STAHL

CP447G STEELFIX carbon steel press-fit tee with female thread - pipe end 42x1/2"

54745G02

Areas of application

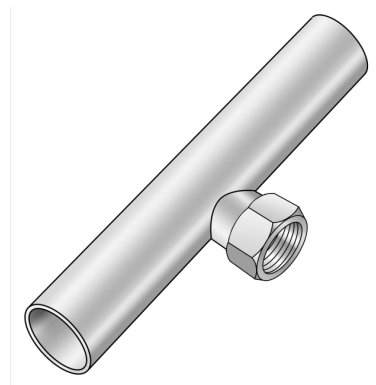

Press tee as pipe end with threaded branch female made of carbon steel coated with a zinc layer
Overall length: 88mm with branch 1/2" female in the middle

Specifications

Article information

port 1	Schiebeende
port 2	Innengewinde (metrisch)
port 3	Schiebeende
execution	T-Stück
angle	90 °
press contour	M

Technical properties

maximum working pressure at 20 ° C	16 bar
------------------------------------	--------

Product information

VPE1	2,00 SA1
VPE2	8,00 KT1
weight	0,470 KGM
text	STEELFIX carbon steel press-fit tee with female thread - pipe end
INTRNR	73079980
main material group	STEELFIX
material group	C-STAHL pressfittings
code	CP447G

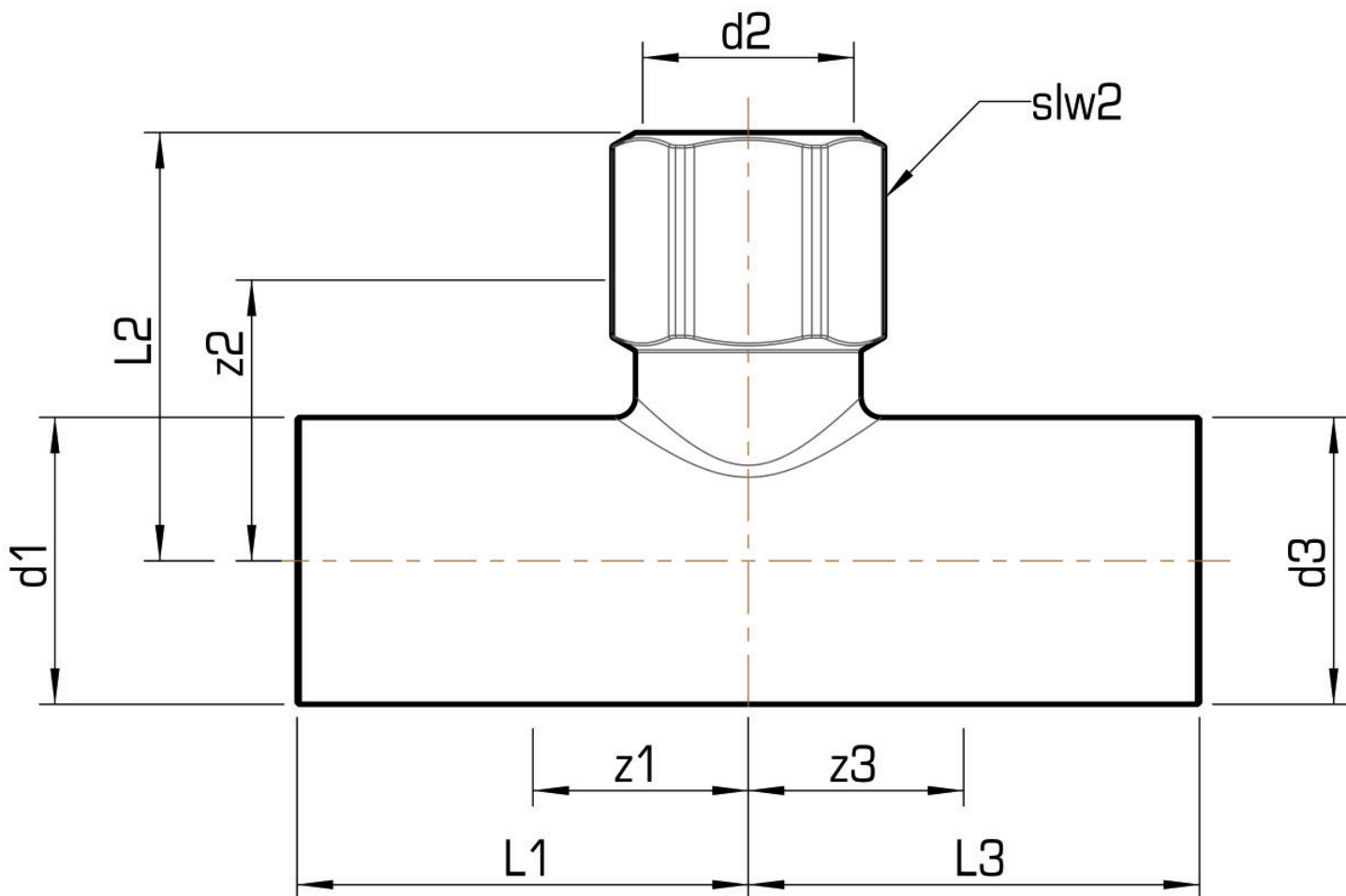

Art. No	label	d2 Inches	d1 mm	d3 mm	L1 mm	L2 mm	L3 mm	z1 mm	z2 mm	z3 mm	slw1 mm
54745G0	42x1/2"	1/2" (15)	42	42	49	49,5	49	19	33	19	24