

# KETRIX

## TRI60 KETRIX end cap 25

55120E00

### Areas of application

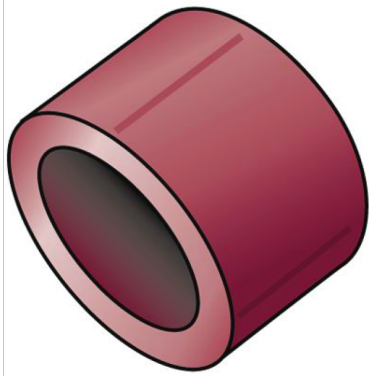

KETRIX polyfusion weld fitting for connecting POB pipes to fittings made of the same material without narrowing the cross section

# Specifications

## Article information

**port 1** Plastic welding socket

## Product information

<b>VPE1</b>	10,00 SA1
<b>VPE2</b>	200,00 KT1
<b>VPE3</b>	1200,00 KT2
<b>VPE4</b>	19200,00 PAL
<b>weight</b>	0,018 KGM
<b>text</b>	KETRIX end cap
<b>INTRNR</b>	39174000
<b>main material group</b>	KETRIX
<b>material group</b>	KETRIX plastic fittings
<b>code</b>	TRI60

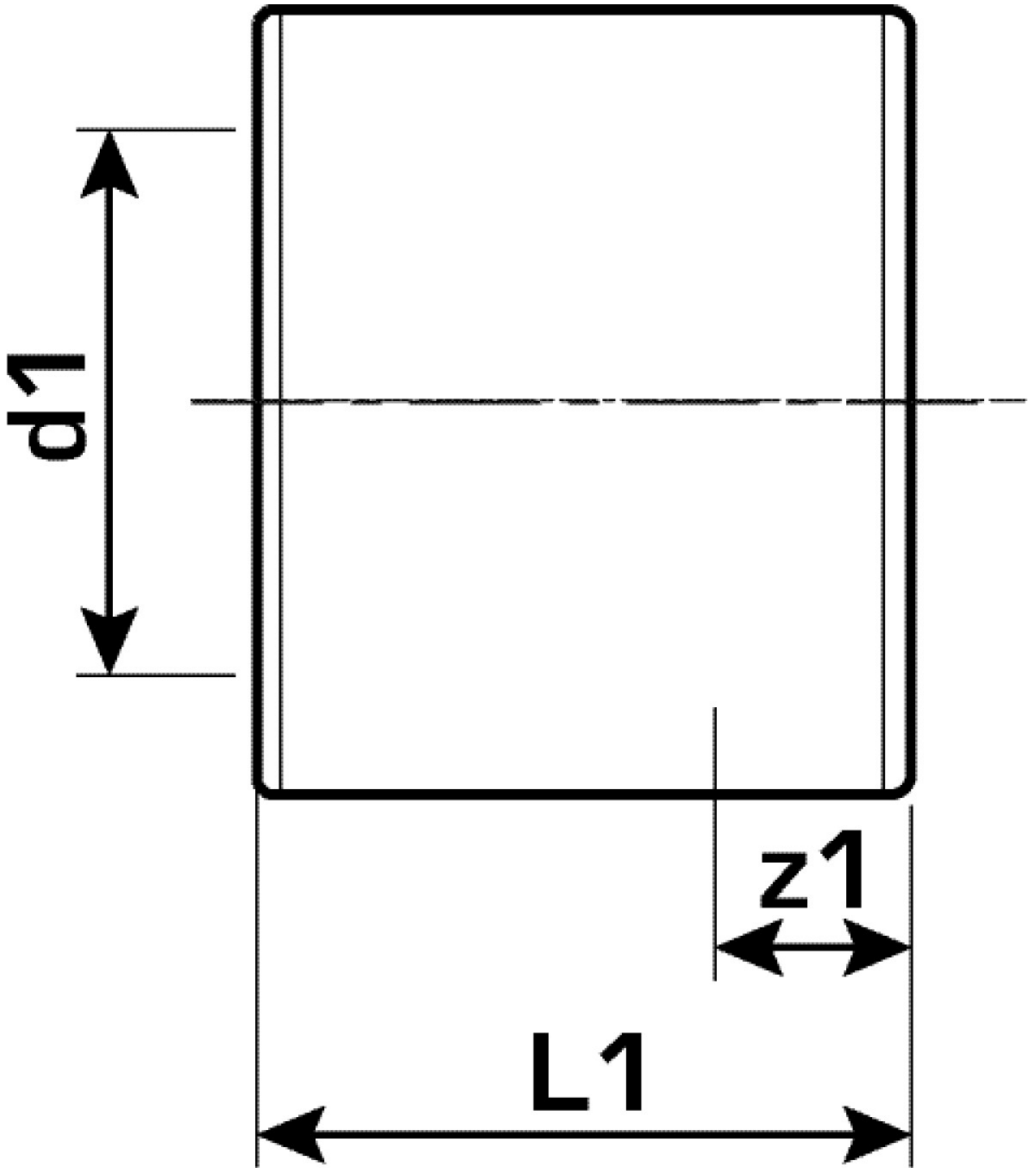

Art. No	label	d1 mm	L1 mm	z1 mm
55120E00	25	25	30	10



**KE KELIT GmbH**

A 4020 Linz, Ignaz-Mayer-Straße 17, Austria, Europe

**PHONE** +43 (0) 50 779 **E-MAIL** [office@kekelit.com](mailto:office@kekelit.com)

[www.kekelit.com](http://www.kekelit.com)