

# STEEL FIX EDELSTAHL

NPI415 STEELFIX industrial stainless steel press-fit repair coupling 35

53305FF0

## Areas of application



Press-fit repair coupling straight made of stainless steel 1.4301, incl. EPDM sealing elements, d15-54 "leak before pressed"

Press contour: M

ATTENTION: NOT suitable for drinking water!

# Specifications

## Article information

|               |            |
|---------------|------------|
| port 1        | Pressmuffe |
| port 2        | Pressmuffe |
| execution     | 1-teilig   |
| design        | gerade     |
| press contour | M          |

## Technical properties

|                         |       |
|-------------------------|-------|
| insertion depth 1 (es1) | 30 mm |
|-------------------------|-------|

## Product information

|        |   |
|--------|---|
| VPE1   | 5,00 SA1  |
| VPE2   | 20,00 KT1   |
| VPE3   | 500,00 PAL  |
| weight | 0,160 KGM   |
| text   | STEELFIX industrial stainless steel press-fit repair coupling |
| INTRNR | 73072980  |
| code   | NPI415  |

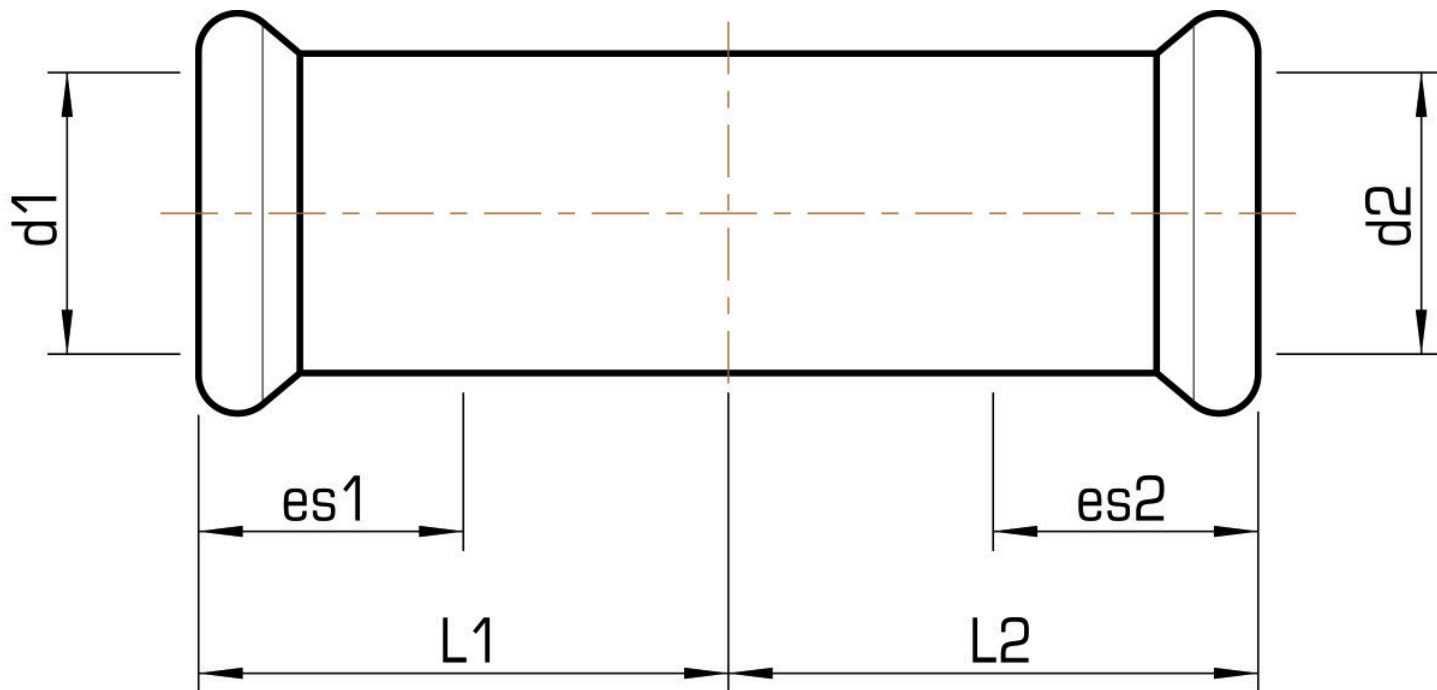

| Art. No  | label | d1 mm | d2 mm | L1 mm | L2 mm | insertion depth 1 (es1) mm | Insertion depth 2 (es2) mm |
|----------|-------|-------|-------|-------|-------|----------------------------|----------------------------|
| 53305FF0 | 35    | 35    | 35    | 51    | 51    | 30                         | 30                         |