

# STEEL FIX EDELSTAHL

NPI426 STEELFIX industrial stainless steel press-fit elbow 45° male/female 15

53321BB0

## Areas of application

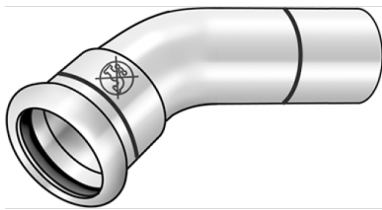

Press-elbow 45° m/f stainless steel 1.4301, incl. EPDM sealing elements, of d15-54 "leak before pressed"

Press contour: M

ATTENTION: NOT suitable for drinking water!

# Specifications

## Article information

|               |                 |
|---------------|-----------------|
| port 1        | Pressmuffe      |
| port 2        | Zapfen/Rohrende |
| execution     | 1-teilig        |
| design        | Bogen           |
| angle         | 45 °            |
| press contour | M               |

## Product information

|        |  |
|--------|--|
| VPE1   | 10,00 SA1  |
| VPE2   | 150,00 KT1   |
| VPE3   | 3750,00 PAL  |
| weight | 0,040 KGM  |
| text   | STEELFIX industrial stainless steel press-fit elbow 45°<br>male/female |
| INTRNR | 73072980   |
| code   | NPI426   |

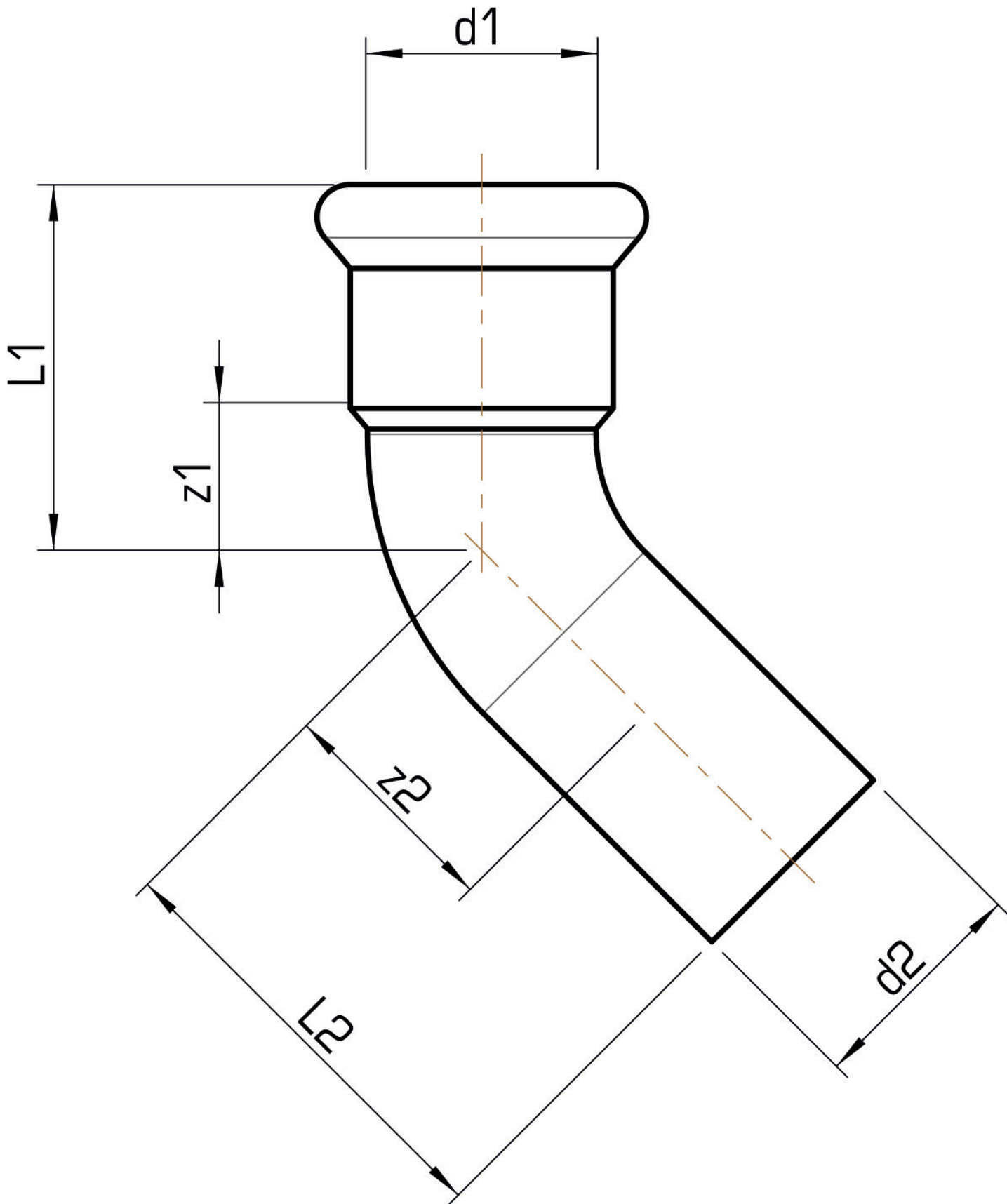

| Art. No  | label | d1 mm | d2 mm | L1 mm | L2 mm | z1 mm | z2 mm |
|----------|-------|-------|-------|-------|-------|-------|-------|
| 53321BB0 | 15    | 15    | 15    | 31    | 38    | 11    | 18    |



**KE KELIT GmbH**

A 4020 Linz, Ignaz-Mayer-Straße 17, Austria, Europe

**PHONE** +43 (0) 50 779 **E-MAIL** [office@kekelit.com](mailto:office@kekelit.com)

[www.kekelit.com](http://www.kekelit.com)