

# STEEL FIX EDELSTAHL

NPI460 STEELFIX industrial stainless steel press-fit adapter elbow 90° with male thread 28x1"

53812E05

## Areas of application

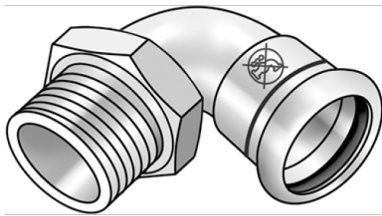

Press-elbow adapter 90° with male thread conforming to EN 10226-1 made of stainless steel 1.4301, incl. EPDM sealing components, d15-54 "leak before pressed"

Press contour: M

ATTENTION: NOT suitable for drinking water!

# Specifications

## Article information

port 1	Pressmuffe
port 2	Außengewinde konisch (NPT)
execution	1-teilig
design	Winkel
angle	90 °
press contour	M

## Product information

VPE1	10,00 SA1
VPE2	30,00 KT1
VPE3	750,00 PAL
weight	0,230 KGM
text	STEELFIX industrial stainless steel press-fit adapter elbow 90° with male thread
INTRNR	73072980
code	NPI460

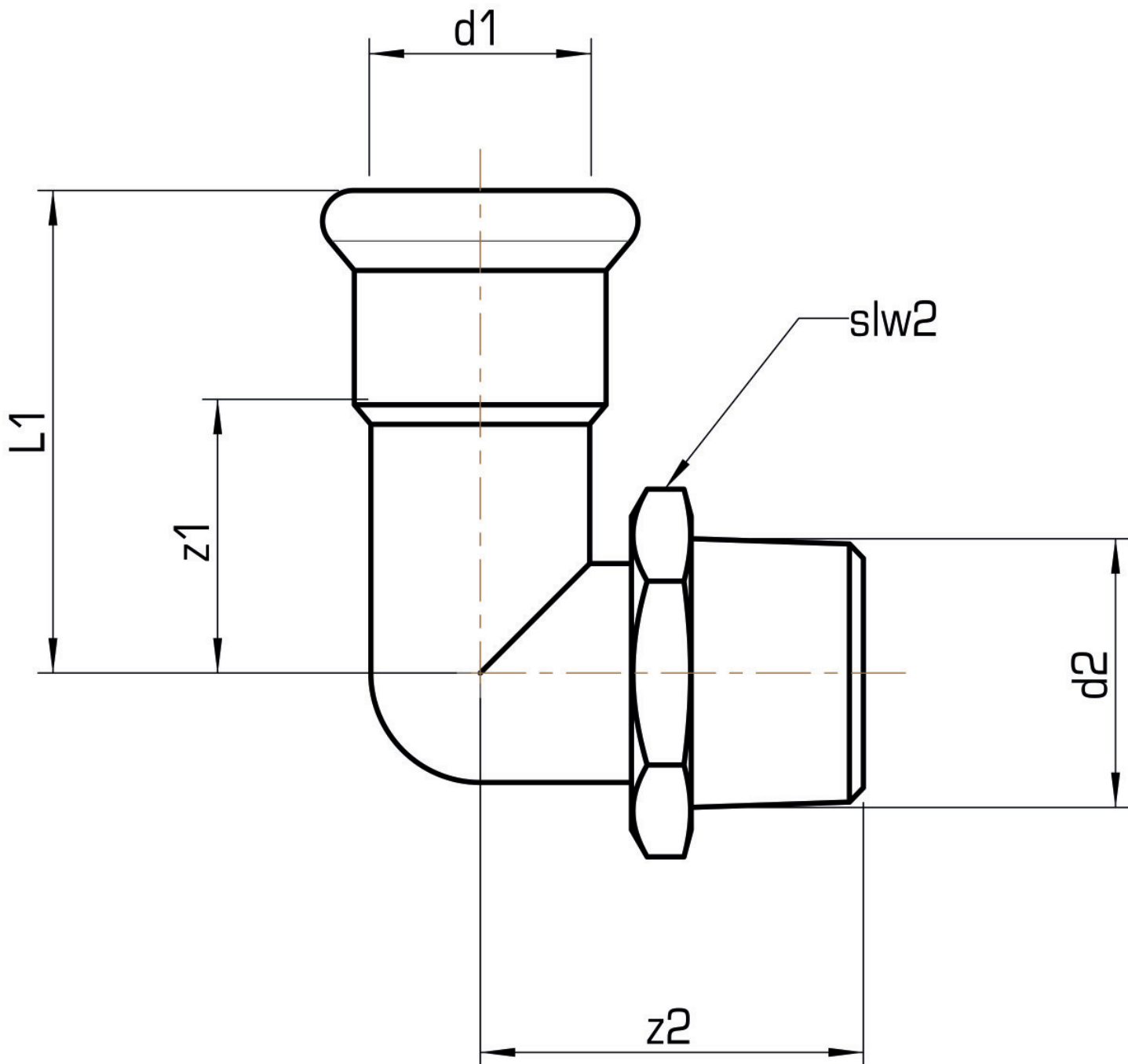

Art. No	label	d2 Zoll	d1 mm	L1 mm	z1 mm	z2 mm	slw2 mm
53812E05	28x1"	1 Zoll (25)	28	53	30	46	38