

# KELOX

## KMU485SB KELOX-ULTRAX connection set with elbow 20x1/2" 8-10cm

71264D02

### Areas of application

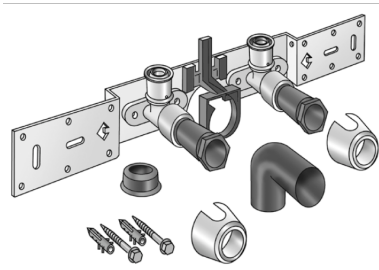

With KMU480 wall bracket fitting elbow 90°, sound-insulated; stopper, metal mount, plugs and fastening elements, incl. elbow for connecting to trap d50mm and galvanised nipple d30  
DO NOT screw in any threaded pipes and cast iron fittings!

### Approvals:



KE KELIT GmbH

A 4020 Linz, Ignaz-Mayer-Straße 17, Austria, Europe

PHONE +43 (0) 50 779 E-MAIL [office@kekelit.com](mailto:office@kekelit.com)

[www.kekelit.com](http://www.kekelit.com)

# Specifications

Product information	
VPE1	1,00 KT1
VPE2	15,00 KT2
weight	1,053 KGM
text	KELOX-ULTRAX connection set with elbow
INTRNR	74122000
main material group	KELOX
material group	KELOX-ULTRAX metal fittings
code	KMU485SB

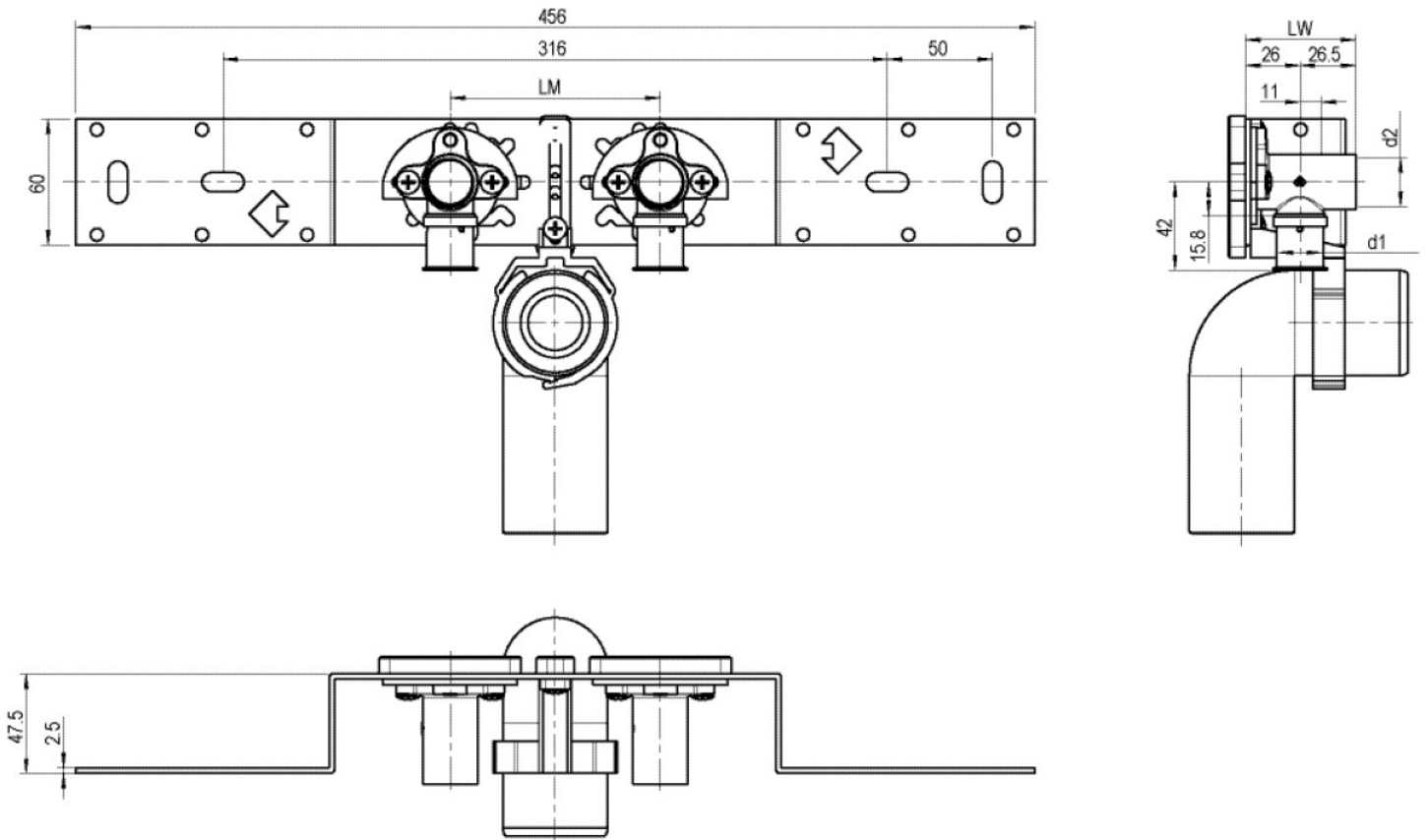

Art. No	label
71264D02	20x1/2" 8-10cm



**KE KELIT GmbH**  
 A 4020 Linz, Ignaz-Mayer-Straße 17, Austria, Europe  
**PHONE** +43 (0) 50 779 **E-MAIL** office@kekelit.com  
 www.kekelit.com