

KELOX_{FB}

KM593T KELOX 6/4" connection ball valve with thermometer 6/4" straight

90049050

Areas of application

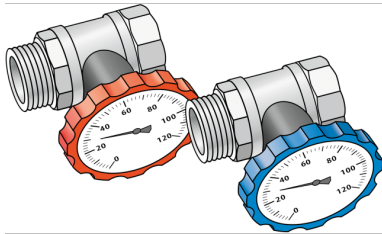

?Straight connecting ball valves for shutting off 6/4" manifolds, with flat-sealing male thread to the manifold bar, including seal, thermometer from 0-120°C, non-porous metallised brass

Specifications

Article information

port 1	Außengewinde konisch (NPT)
port 2	Innengewinde zylindrisch (BSPP)
execution	gerade

Product information

VPE1	1,00 KT1
VPE2	10,00 KT2
weight	2,750 KGM
text	KELOX 6/4" connection ball valve with thermometer
INTRNR	84818081
code	KM593T

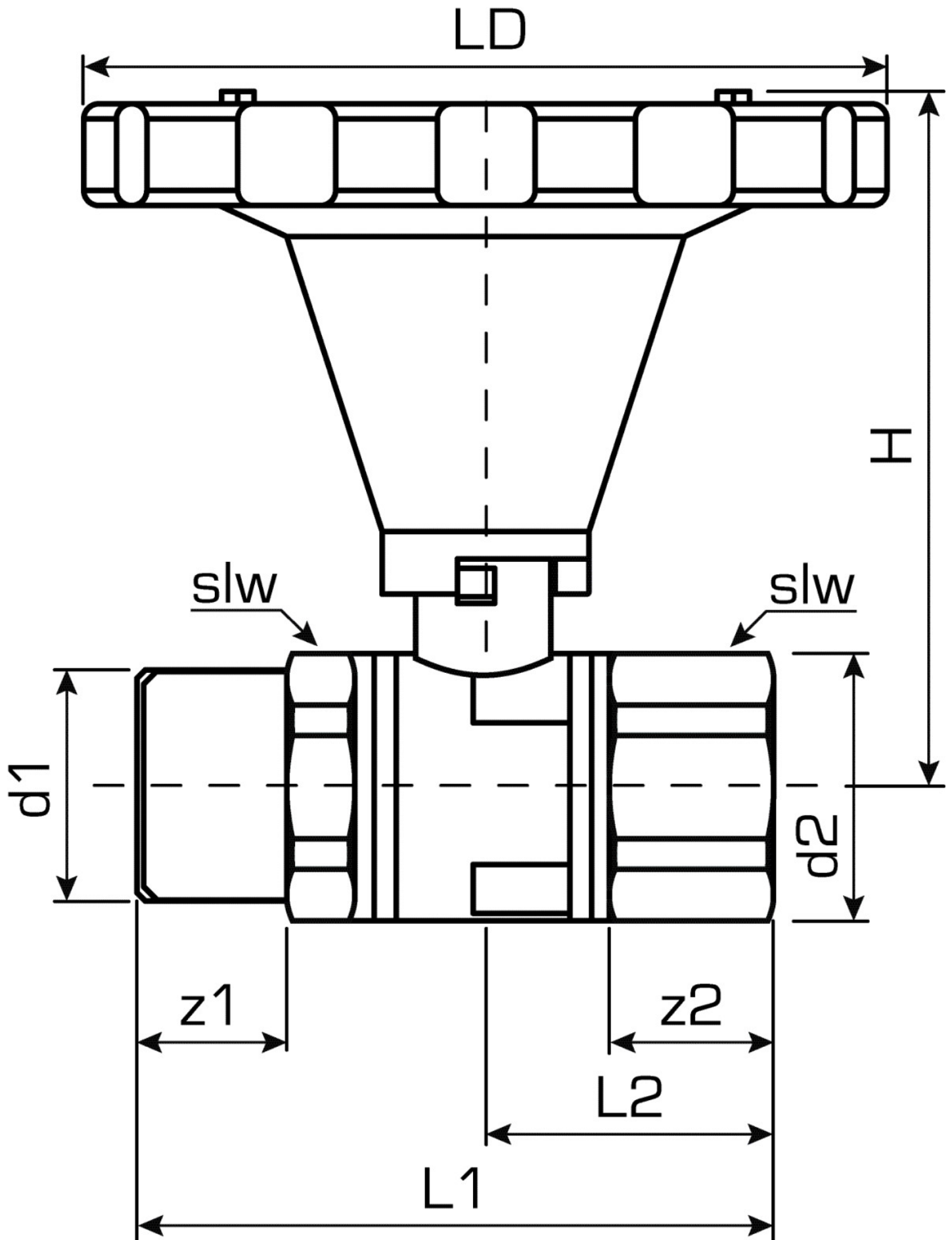

Art. No	label	L1 mm	L2 mm	z1 mm	z2 mm
90049050	6/4" straight	95	42	17	14,5



KE KELIT GmbH

A 4020 Linz, Ignaz-Mayer-Straße 17, Austria, Europe

PHONE +43 (0) 50 779 **E-MAIL** office@kekelit.com

www.kekelit.com