

STEEL FIX EDELSTAHL

NPI460 STEELFIX industrial stainless steel press-fit adapter elbow 90° with male thread 18x1/2"

53812C02

Areas of application

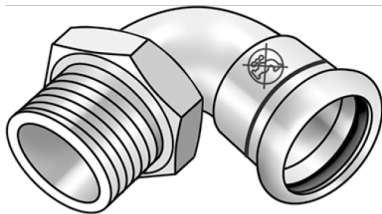

Press-elbow adapter 90° with male thread conforming to EN 10226-1 made of stainless steel 1.4301, incl. EPDM sealing components, d15-54 "leak before pressed"

Press contour: M

ATTENTION: NOT suitable for drinking water!

Specifications

Article information

port 1	Pressmuffe
port 2	Außengewinde konisch (NPT)
execution	1-teilig
design	Winkel
angle	90 °
press contour	M

Product information

VPE1	10,00 SA1
VPE2	60,00 KT1
VPE3	1500,00 PAL
weight	0,120 KGM
text	STEELFIX industrial stainless steel press-fit adapter elbow 90° with male thread
INTRNR	73072980
code	NPI460

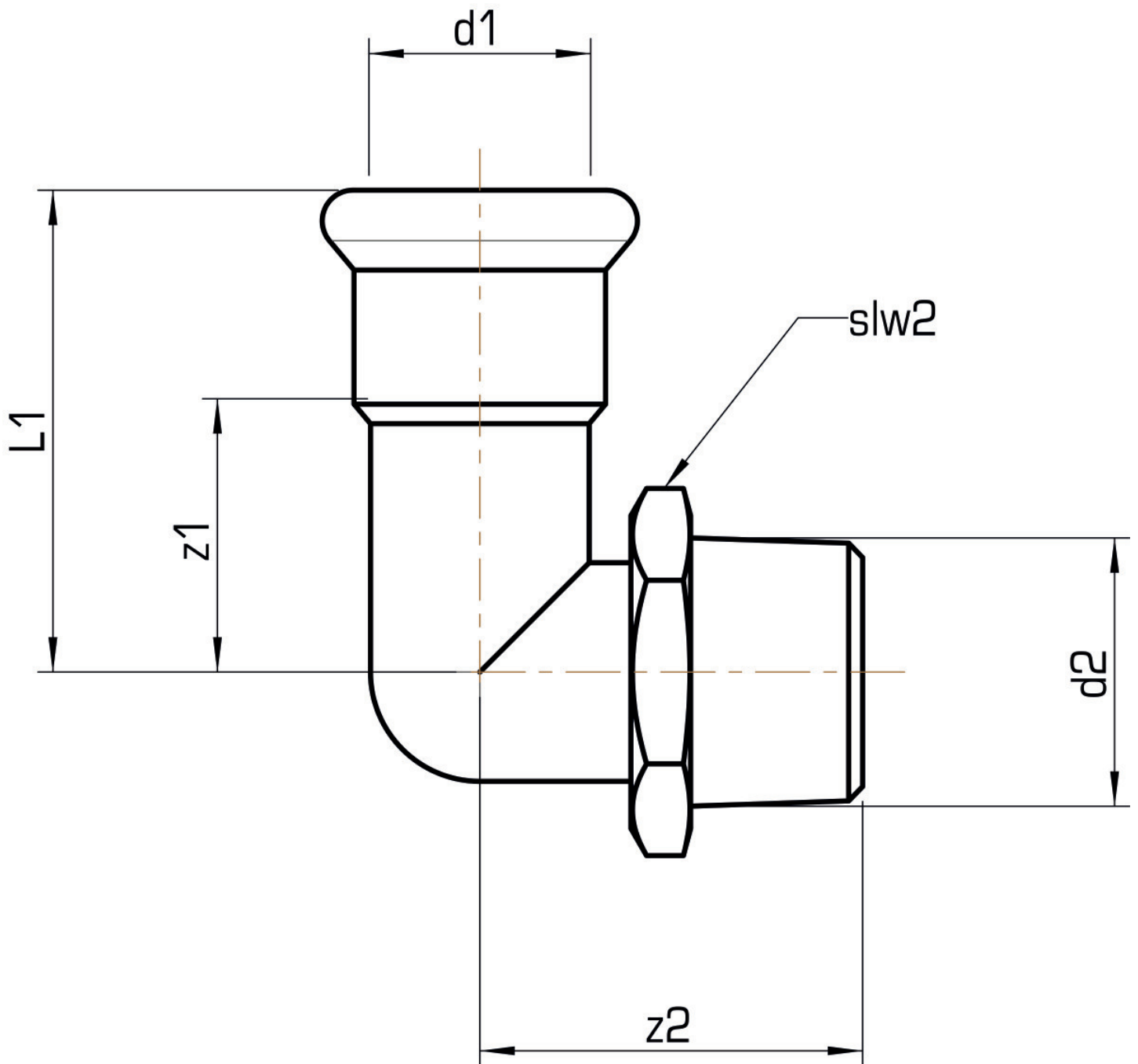

Art. No	label	d2 Zoll	d1 mm	L1 mm	z1 mm	z2 mm	slw2 mm
53812C02	18x1/2"	1/2 Zoll (15)	18	43,5	23,5	31,5	24