

# STEEL FIX C-STAHl

CP424 STEELFIX carbon steel press-fit-elbow  
30° male/female 76,1

54619JJ0

## Areas of application

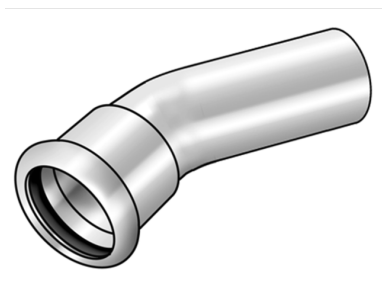

Press-elbow 30°, f/m, made of carbon steel coated with a zinc layer, incl. EPDM sealing components, d42-54 "leak before pressed"

Press contour: M

# Specifications

## Article information

|               |            |
|---------------|------------|
| port 1        | Pressmuffe |
| port 2        | Pressmuffe |
| execution     | 1-part     |
| design        | Winkel     |
| angle         | 30 °       |
| press contour | M          |

## Technical properties

|                                    |        |
|------------------------------------|--------|
| maximum working pressure at 20 ° C | 16 bar |
|------------------------------------|--------|

## Product information

|                     |   |
|---------------------|---|
| VPE1                | 2,00 SA1  |
| VPE2                | 12,00 KT1   |
| weight              | 1,410 KGM   |
| text                | STEELFIX carbon steel press-fit-elbow 30° male/female |
| INTRNR              | 73079980  |
| main material group | STEELFIX  |
| material group      | C-STAHl pressfittings                                 |
| code                | CP424   |

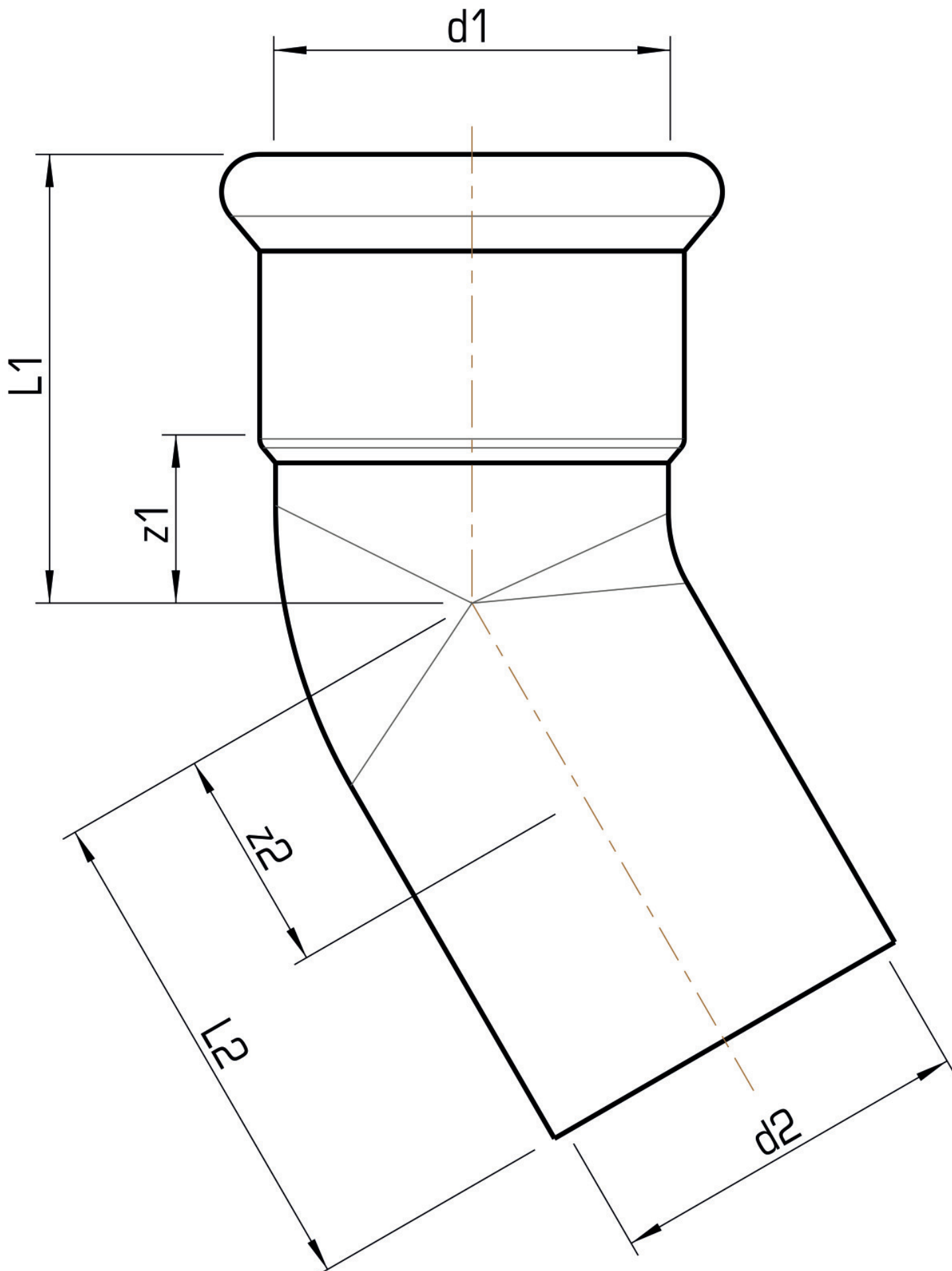

| Art. No  | label | d1 mm | d2 mm | L1 mm | L2 mm | z1 mm | z2 mm |
|----------|-------|-------|-------|-------|-------|-------|-------|
| 54619JJ0 | 76,1  | 76,1  | 76,1  | 90,5  | 92    | 35,5  | 37    |



**KE KELIT GmbH**

A 4020 Linz, Ignaz-Mayer-Straße 17, Austria, Europe

**PHONE** +43 (0) 50 779 **E-MAIL** [office@kekelit.com](mailto:office@kekelit.com)

[www.kekelit.com](http://www.kekelit.com)