

STEEL FIX C-STAHL

CP424 STEELFIX carbon steel press-fit-elbow
30° male/female 88,9

54619KK0

Areas of application

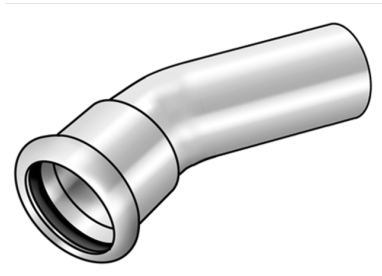

Press-elbow 30°, f/m, made of carbon steel coated with a zinc layer, incl. EPDM sealing components, d42-54 "leak before pressed"

Press contour: M

Specifications

Article information

| | |
|---------------|------------|
| port 1 | Pressmuffe |
| port 2 | Pressmuffe |
| execution | 1-part |
| design | Winkel |
| angle | 30 ° |
| press contour | M |

Technical properties

| | |
|------------------------------------|--------|
| maximum working pressure at 20 ° C | 16 bar |
|------------------------------------|--------|

Product information

| | |
|---------------------|---|
| VPE1 | 2,00 SA1 |
| VPE2 | 8,00 KT1 |
| weight | 1,850 KGM |
| text | STEELFIX carbon steel press-fit-elbow 30° male/female |
| INTRNR | 73079980 |
| main material group | STEELFIX |
| material group | C-STAHL pressfittings |
| code | CP424 |

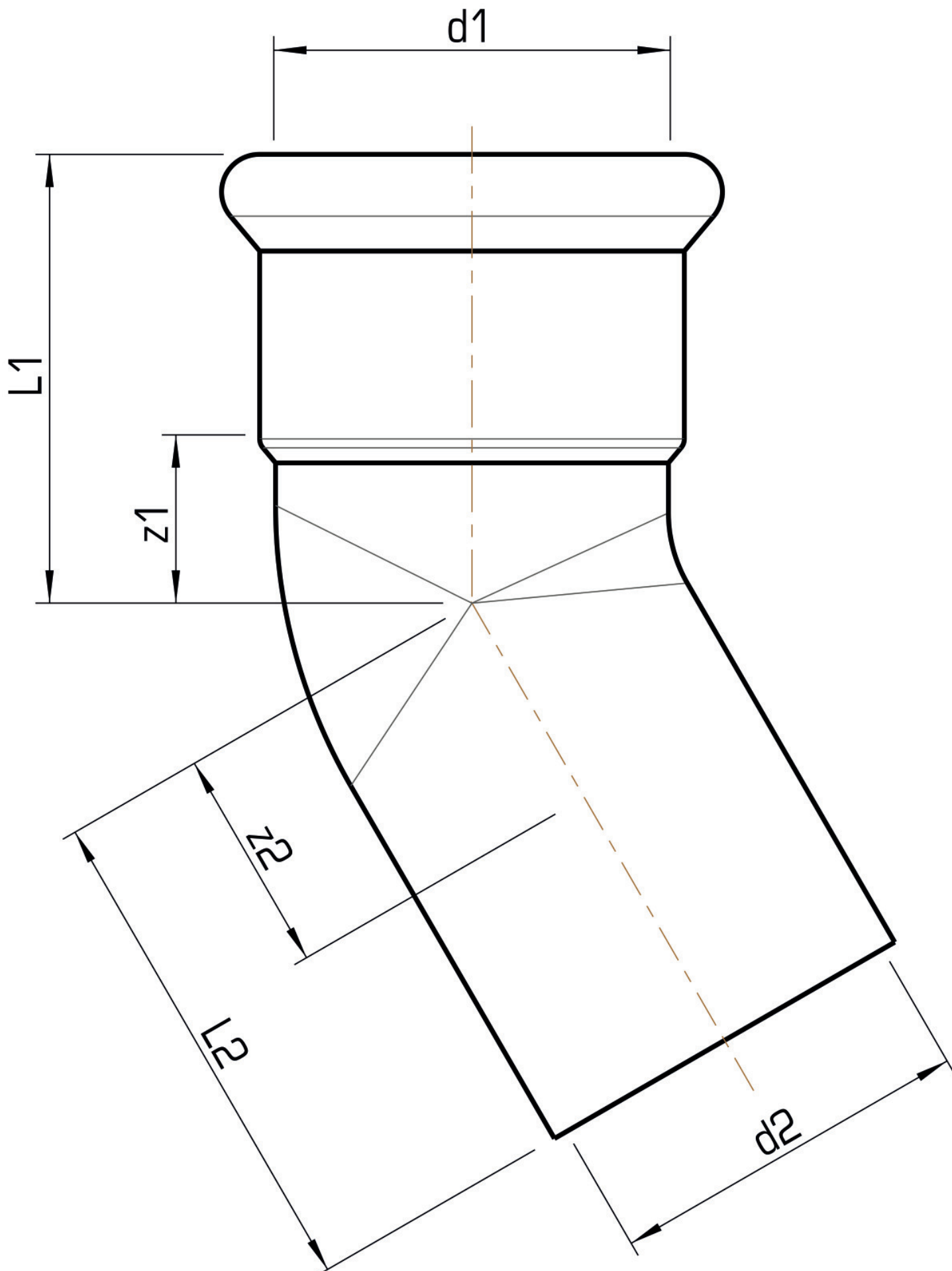

| Art. No | label | d1 mm | d2 mm | L1 mm | L2 mm | z1 mm | z2 mm |
|----------|-------|-------|-------|-------|-------|-------|-------|
| 54619KK0 | 88,9 | 88,9 | 88,9 | 94,5 | 117 | 31,5 | 54 |



KE KELIT GmbH

A 4020 Linz, Ignaz-Mayer-Straße 17, Austria, Europe

PHONE +43 (0) 50 779 **E-MAIL** office@kekelit.com

www.kekelit.com