

STEEL FIX C-STAHl

CP418 STEELFIX carbon steel press-fit-adapter - groove system 35x42.4

54608F06

Areas of application

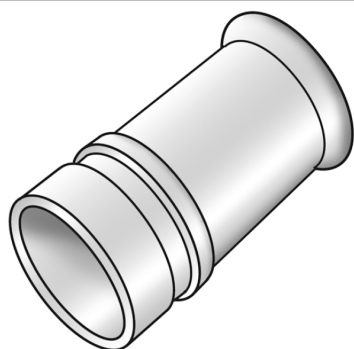

Press-fit adapter on groove system made from carbon steel coated with a zinc layer, incl. EPDM sealing elements, d15-54 "leak before pressed"

Press contour: M

Specifications

Article information

port 1	Pressmuffe
port 2	Nut
execution	1-part
design	gerade
press contour	M

Technical properties

maximum working pressure at 20 ° C	16 bar
------------------------------------	--------

Product information

VPE1	10,00 SA1
VPE2	30,00 KT1
VPE3	750,00 DDP
weight	0,130 KGM
text	STEELFIX carbon steel press-fit-adapter - groove system
INTRNR	73079980
main material group	STEELFIX
material group	C-STAHL pressfittings
code	CP418

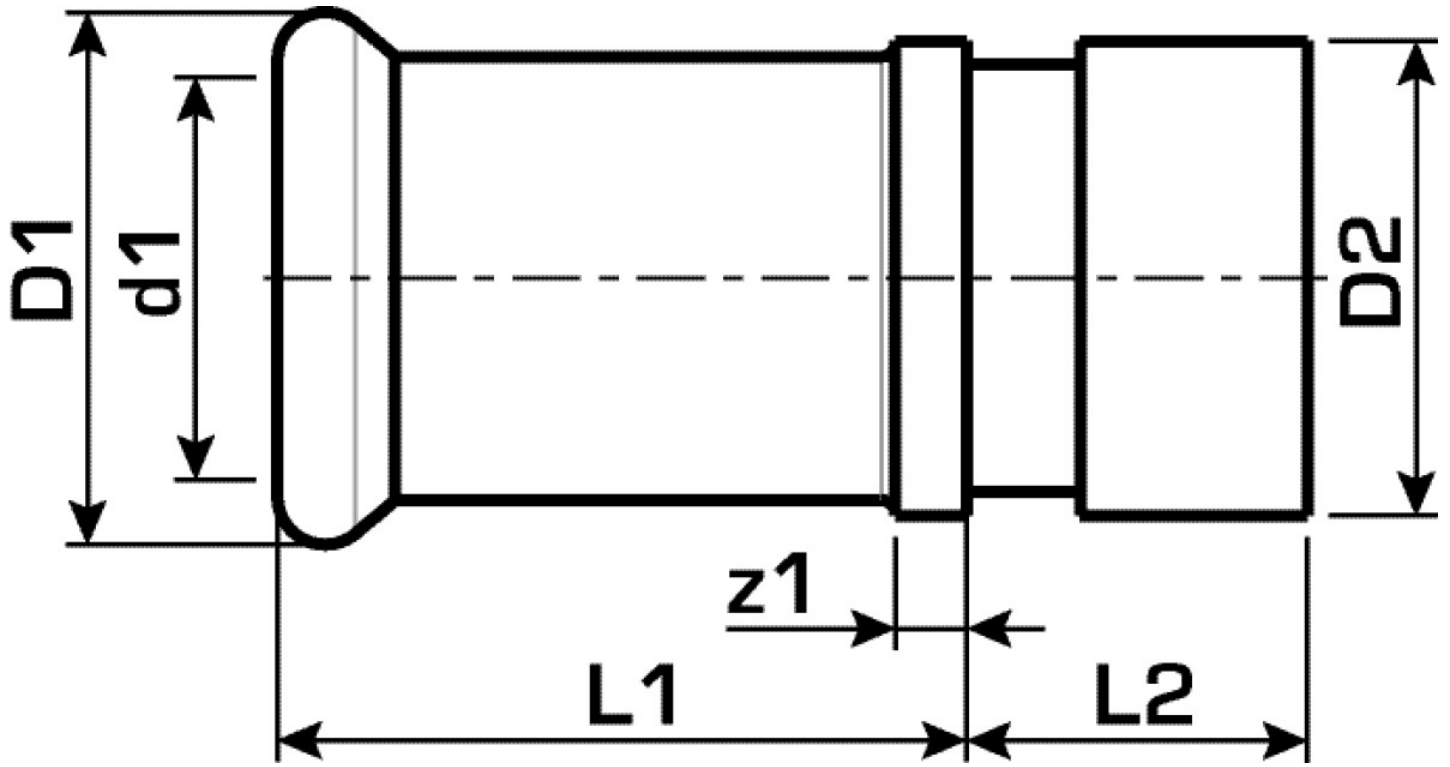

Art. No	label	d2	d1 mm	d2 mm	L1 mm	L2 mm	z1 mm
54608F06	35x42.4	DN 32	35	42,2	54	24	28