

# CLIMATE FIX

KCU440 CLIMATEFIX tee 20/12/20

6351410

## Areas of application

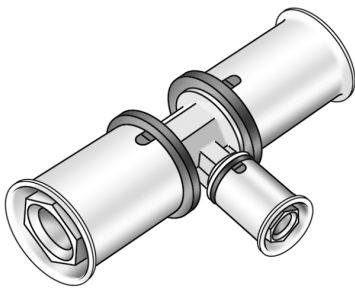

?Press-tee equal or reduced, made of non-porous metal-plated brass, incl. support sleeves with O-rings and stainless steel pressing sleeves. "Leak before pressed"

# Specifications

## Article information

port 1	Pressmuffe
port 2	Pressmuffe
port 3	Pressmuffe
execution	T-Stück
press contour	U

## Product information

VPE1	10,00 SA1
VPE2	50,00 KT1
weight	0,076 KGM
text	CLIMATEFIX tee
INTRNR	74122000
main material group	CLIMATEFIX
material group	CLIMATEFIX fittings
code	KCU440

Art. No	label
6351410	20/12/20