

# KETRON

## KET750 KETRON drinking fountain floor flange D 240mm

21807500

### Areas of application

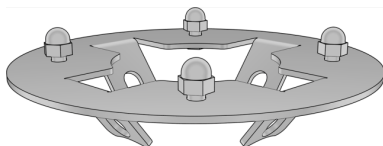

Bottom flange made of V4A stainless steel with tabs for concreting. With fastening bolts and cap nuts. For fastening KETRON drinking fountains. Insertion diameter 95 mm. (ATTENTION: Pay attention to hole circle positioning for drinking fountains!)

# Specifications

Product information	
VPE1	1,00 KT1
weight	1,500 KGM
text	KETRON drinking fountain floor flange
INTRNR	73089098
code	KET750

Art. No	label
21807500	D 240mm