

KELEN

KE20 KELEN PP-RCT elbow 90° 75

2504501

Areas of application

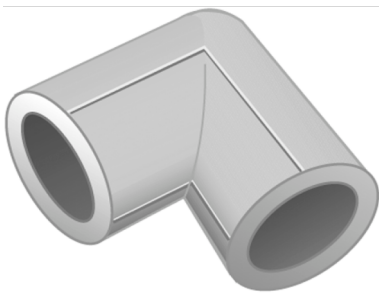

KELEN PP-RCT Polyfusion welding fitting for connecting pipes with fittings made of the same material (no reduction of internal diameter)

Approvals:



Specifications

Article information

| | |
|-----------|------------------------|
| port 1 | Kunststoffschweißmuffe |
| port 2 | Kunststoffschweißmuffe |
| execution | 1-part |
| design | Winkel |
| angle | 90 ° |

Product information

| | |
|---------------------|------------------------|
| VPE1 | 1,00 SA1 |
| VPE2 | 4,00 KT1 |
| VPE3 | 24,00 KT2 |
| VPE4 | 384,00 PAL |
| weight | 0,540 KGM |
| text | KELEN PP-RCT elbow 90° |
| INTRNR | 39174000 |
| main material group | KELEN |
| material group | KELEN plastic fittings |
| code | KE20 |

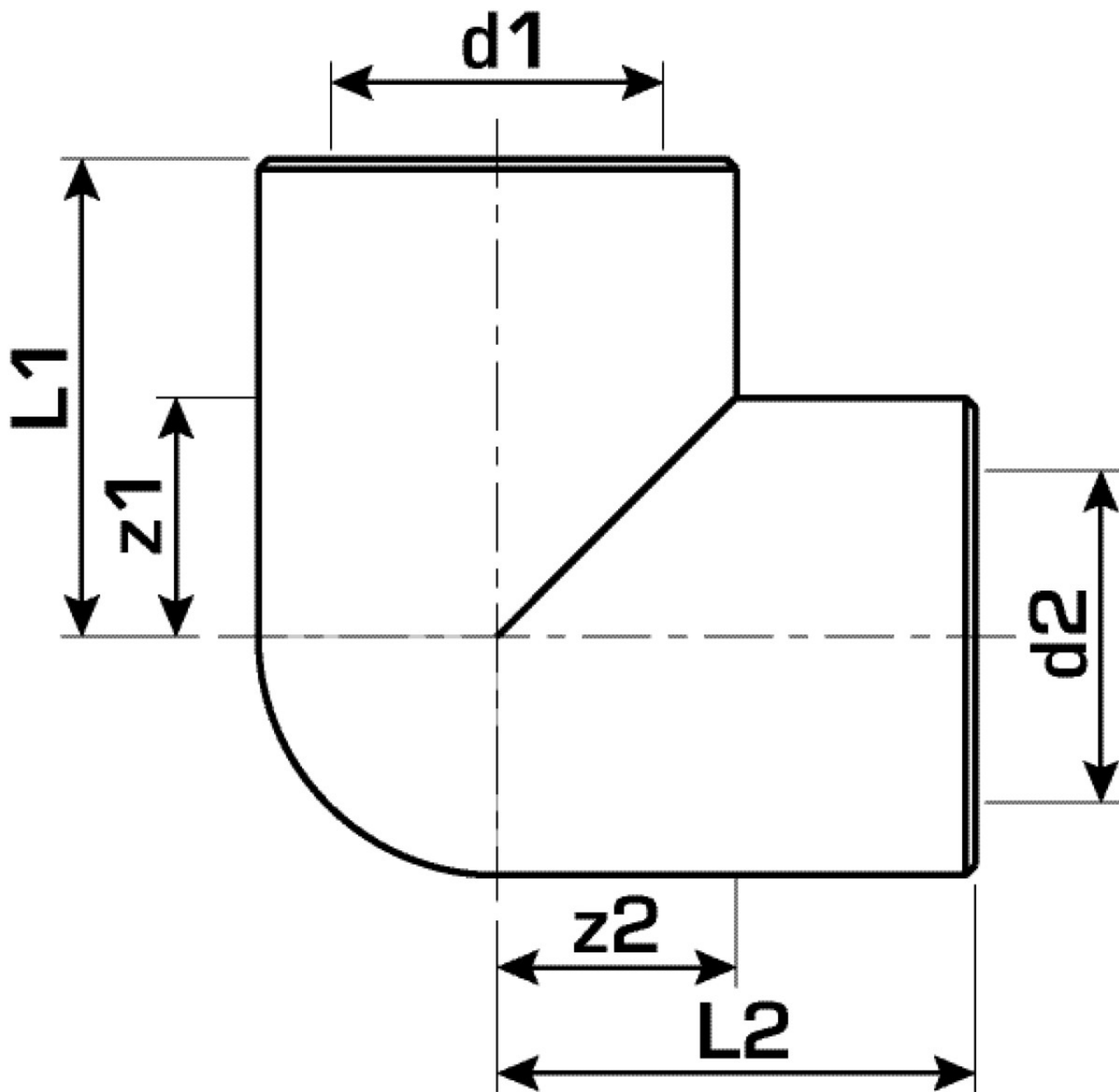

| Art. No | label | d1 mm | d2 mm | L1 mm | L2 mm | z1 mm | z2 mm |
|---------|-------|-------|-------|-------|-------|-------|-------|
| 2504501 | 75 | 75 | 75 | 72 | 72 | 41 | 41 |