

KELEN

KE26 KELEN PP-RCT elbow 90° male/female 32

2712501

Areas of application

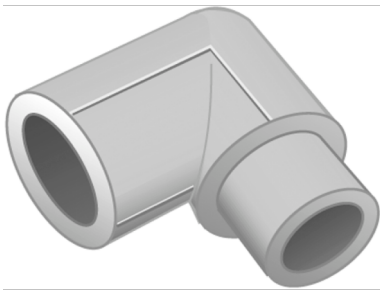

KELEN PP-RCT Polyfusion welding fitting for connecting pipes with fittings made of the same material (no reduction of internal diameter)

Approvals:



Specifications

Article information

| | |
|-----------|------------------------|
| port 1 | Kunststoffschweißmuffe |
| port 2 | Kunststoffschweißende |
| execution | 1-teilig |
| design | Winkel |
| angle | 90 ° |

Product information

| | |
|---------------------|------------------------------------|
| VPE1 | 5 SA1 |
| VPE2 | 40 KT1 |
| VPE3 | 240 KT2 |
| VPE4 | 3840 PAL |
| weight | 0,067 KGM |
| text | KELEN PP-RCT elbow 90° male/female |
| INTRNR | 39174000 |
| main material group | KELEN |
| material group | KELEN plastic fittings |
| code | KE26 |

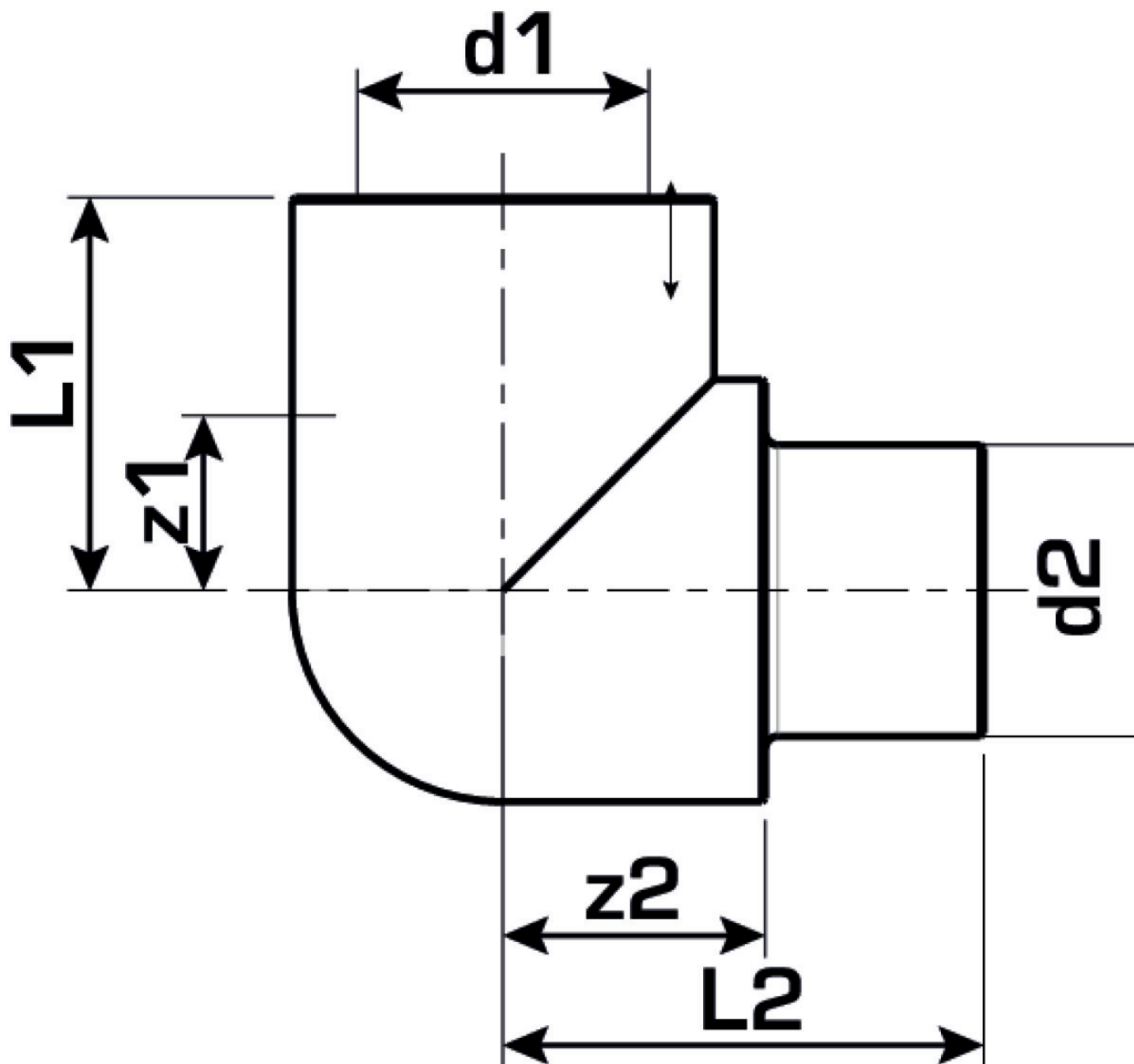

| Art. No | label | d1 mm | d2 mm | L1 mm | L2 mm | z1 mm | z2 mm |
|---------|-------|-------|-------|-------|-------|-------|-------|
| 2712501 | 32 | 32 | 32 | 42 | 52 | 19.5 | 28 |