

# KELEN

## KE10-LX4 KELEN PP-RCT LX-SENSO socket 25

2522041

### Areas of application

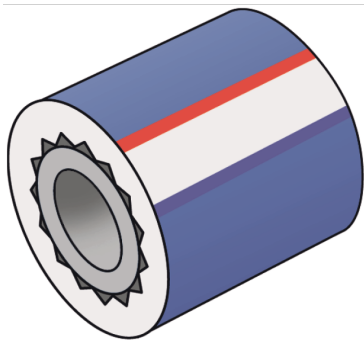

KELEN PP-RCT SENSO Polyfusion welding fitting for connecting pipes with fittings made of the same material (no reduction of internal diameter) and a factory-installed 4mm soft-foam insulation, can be located electronically, outer layer consisting of woven tape fabric and viscoplastic polymer alloy

### Approvals:



KE KELIT GmbH

A 4020 Linz, Ignaz-Mayer-Straße 17, Austria, Europe

PHONE +43 (0) 50 779 E-MAIL [office@kekelit.com](mailto:office@kekelit.com)

[www.kekelit.com](http://www.kekelit.com)

# Specifications

## Article information

port 1	Kunststoffschweißmuffe
port 2	Kunststoffschweißmuffe
design	gerade

## Technical properties

isolation thickness	4 mm
---------------------	------

## Product information

VPE1	10 SA1
VPE2	100 KT1
VPE3	600 KT2
VPE4	9600 PAL
weight	0,023 KGM
text	KELEN PP-RCT LX-SENSO socket
INTRNR	39174000
main material group	KELEN
material group	KELEN-LX fittings
code	KE10-LX4

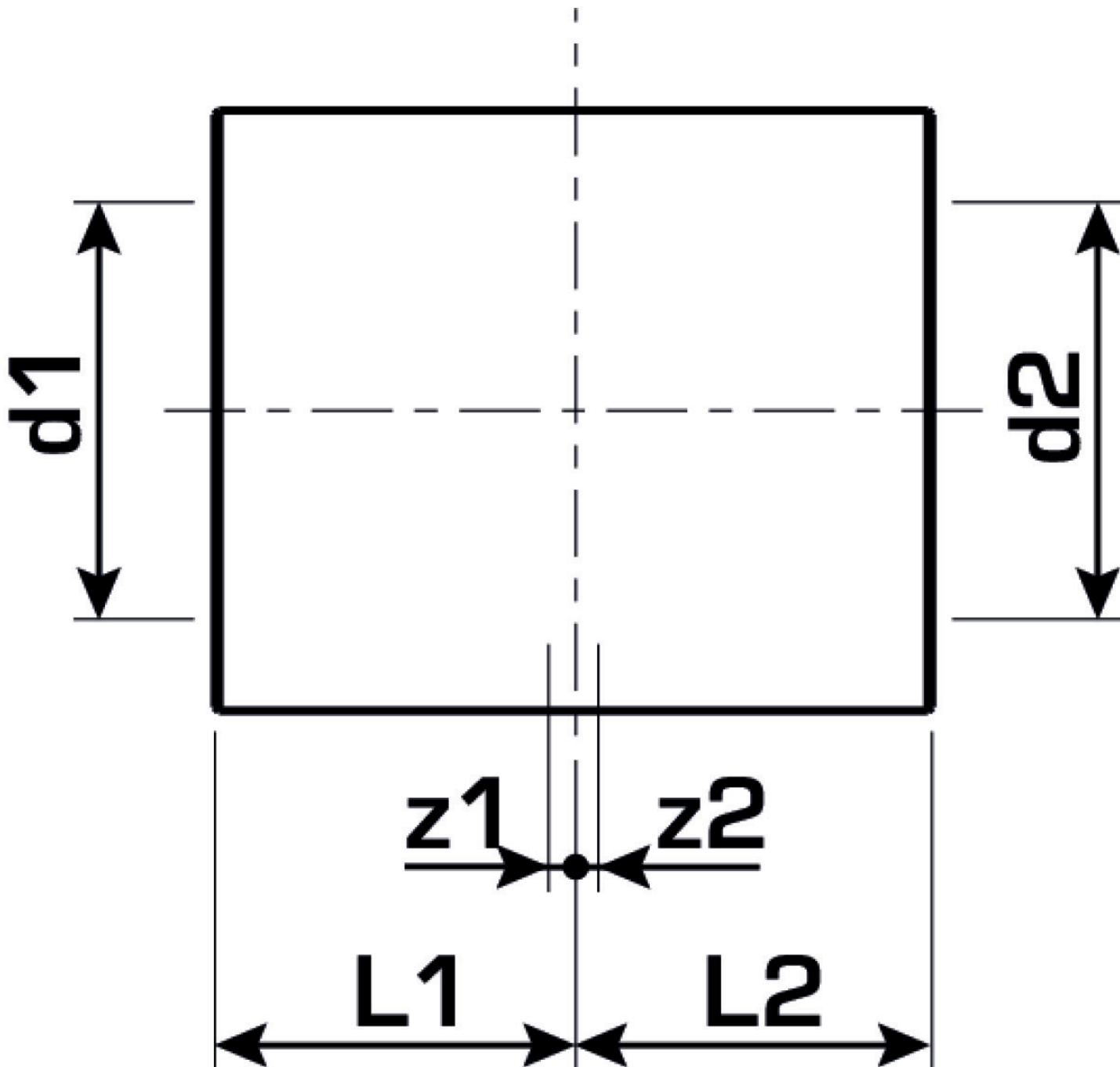

Art. No	label	d1 mm	d2 mm	L1 mm	L2 mm	z1 mm	z2 mm
2522041	25	25	25	21.5	21.5	1.5	1.5