

# STEELOX

SMX455 ?STEELOX union with female thread  
16x1/2"

57203B02

## Areas of application

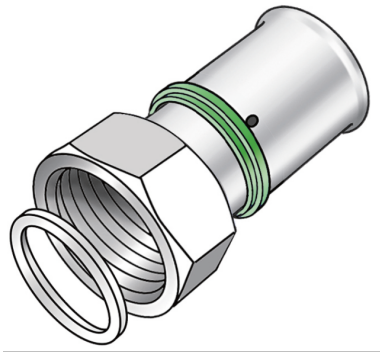

?Press-fit union with female thread for connection to fittings and devices such as filters, manifolds, pumps,..... made of dezincification-resistant (DZR) non-porous metallized brass, incl. support sleeves with O-rings and stainless steel pressing sleeves, "leak before pressed"

## Approvals:



**DIN CERTCO**



KE KELIT GmbH

A 4020 Linz, Ignaz-Mayer-Straße 17, Austria, Europe

PHONE +43 (0) 50 779 E-MAIL [office@kekelit.com](mailto:office@kekelit.com)

[www.kekelit.com](http://www.kekelit.com)

# Specifications

## Article information

port 1	Pressing socket
port 2	Union nut
execution	2-part
design	Straight
press contour	SX

## Technical properties

maximum working pressure at 20 ° C	10 bar
------------------------------------	--------

## Product information

VPE1	10 SA1
VPE2	200 KT1
weight	0,056 KGM
text	?STEELOX union with female thread
INTRNR	74122000
code	SMX455

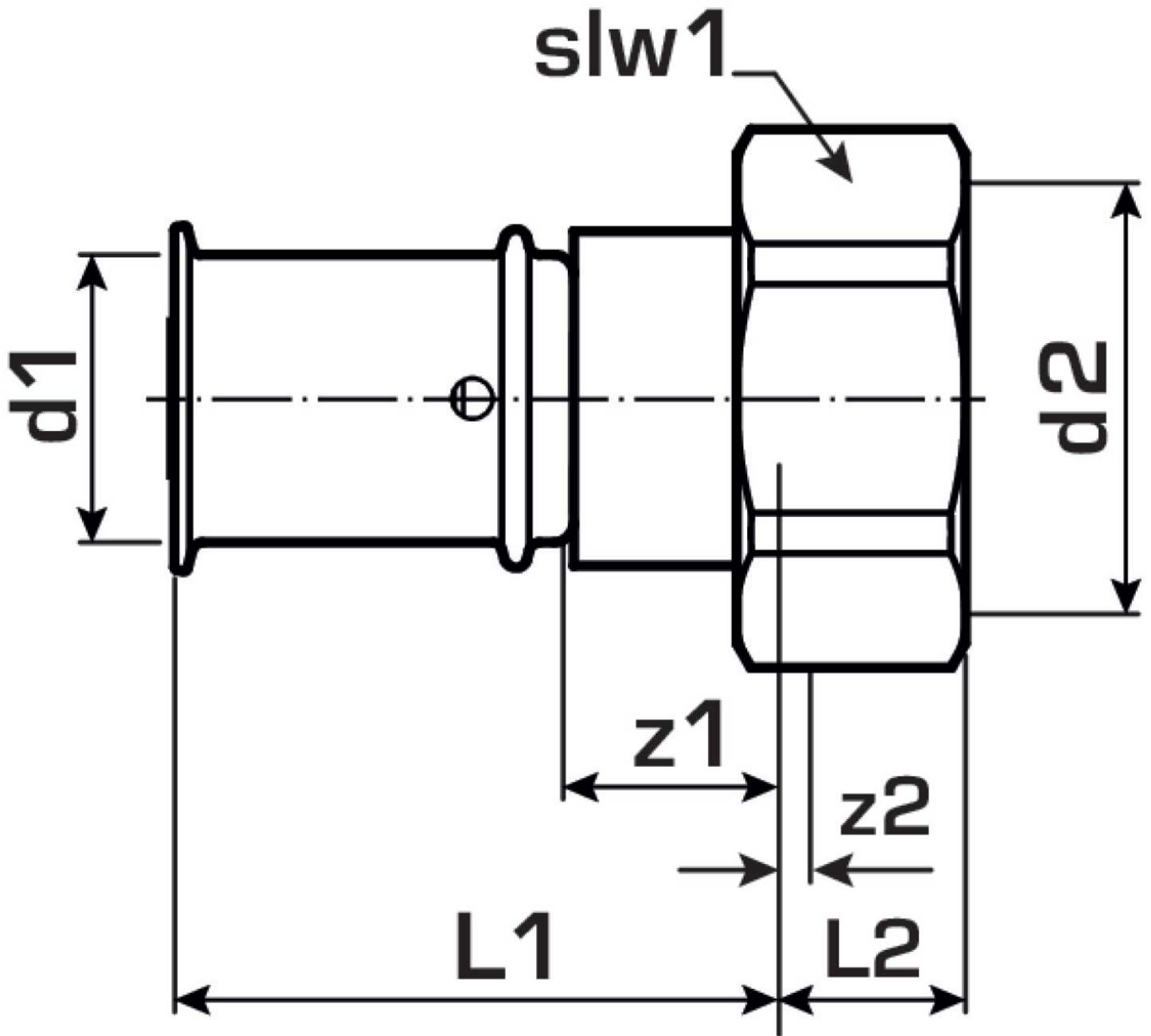

Art. No	label	d2 Inches	d1	L1	L2	z1	z2 mm	slw1
57203B02	16x1/2"	1/2" (15)	16	37	10	13	2	24