

KETRIX

TRI10 KETRIX socket 40

55100GG0

Areas of application

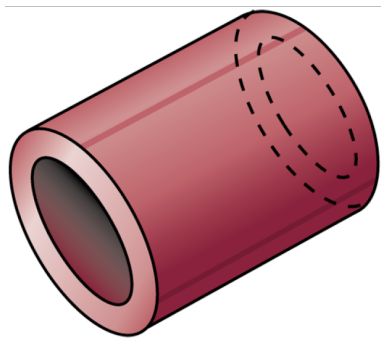

KETRIX polyfusion weld fitting for connecting POB pipes to fittings made of the same material without narrowing the cross section

Specifications

Article information

port 1	Plastic welding socket
port 2	Plastic welding socket
execution	1-part
design	Straight

Product information

VPE1	5 SA1
VPE2	40 KT1
VPE3	240 KT2
VPE4	3840 PAL
weight	0,049 KGM
text	KETRIX socket
INTRNR	39174000
main material group	KETRIX
material group	KETRIX plastic fittings
code	TRI10

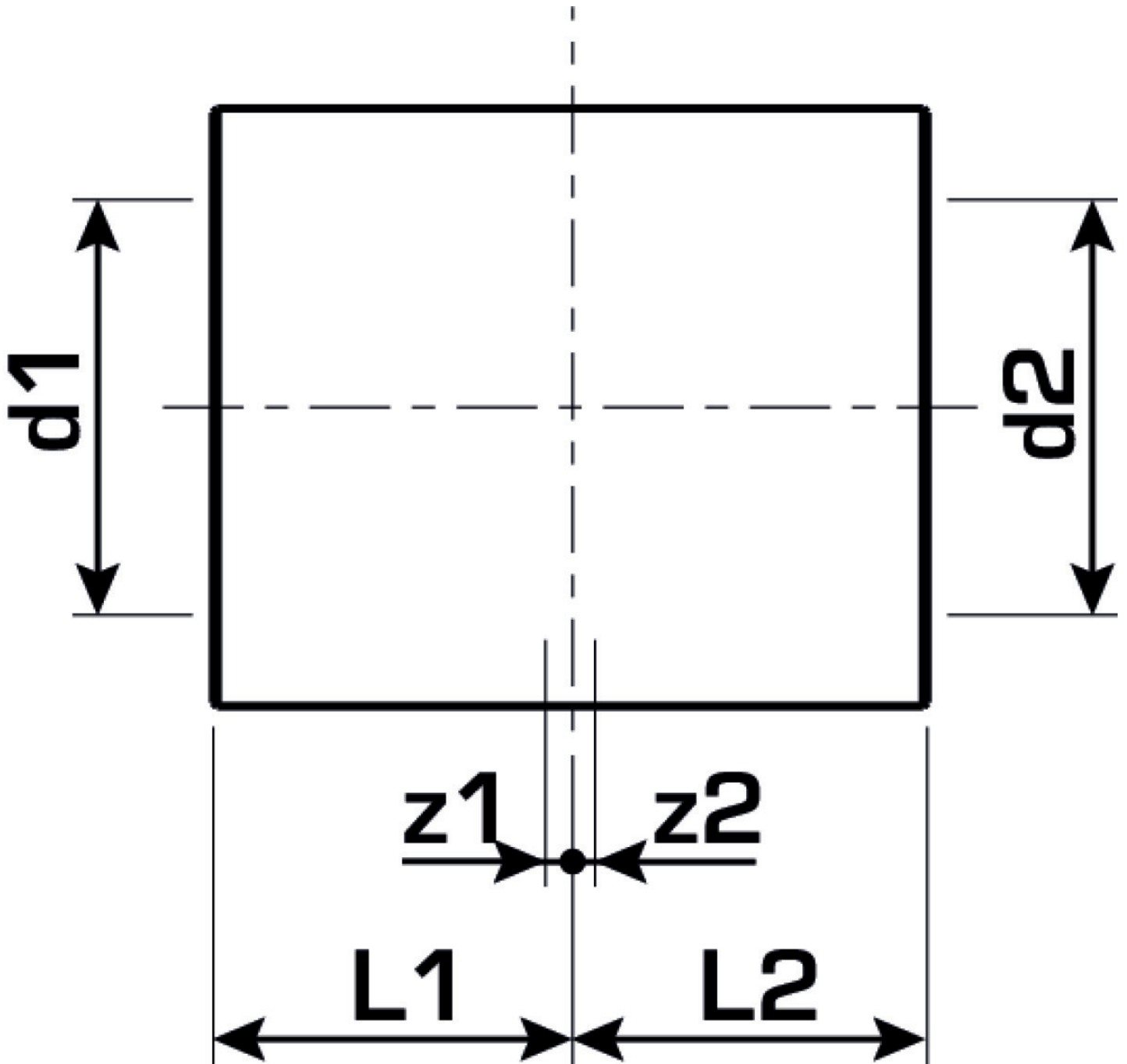

Art. No	label	d2 Inches	d1	d2	L1	L2	z1	z2
55100GG0	40	3/4" (20)	40	40	26.5	26.5	1.5	1.5