

# KETRIX

## TRI31 KETRIX tee with male thread branch 20x1/2"BF

55218DA2

### Areas of application

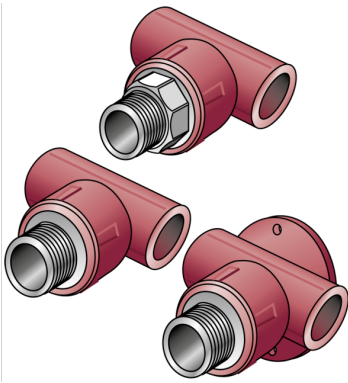

KETRIX polyfusion weld fitting for connecting POB pipes with fittings made of the same material without narrowing the cross-section, with injected male thread made of dezincification-resistant brass and non-porous metal plating, thread conforms to ÖNORM EN 10226

System parts marked with an "S" are produced with a wrench attachment connection

# Specifications

## Technical properties

**maximum working pressure at 20 ° C** 16 bar

## Product information

<b>VPE1</b>	10,00 SA1
<b>VPE2</b>	60,00 KT1
<b>VPE3</b>	240,00 KT2
<b>VPE4</b>	5760,00 PAL
<b>weight</b>	0,115 KGM
<b>text</b>	KETRIX tee with male thread branch
<b>INTRNR</b>	39174000
<b>main material group</b>	KETRIX
<b>material group</b>	KETRIX metal fittings
<b>code</b>	TRI31

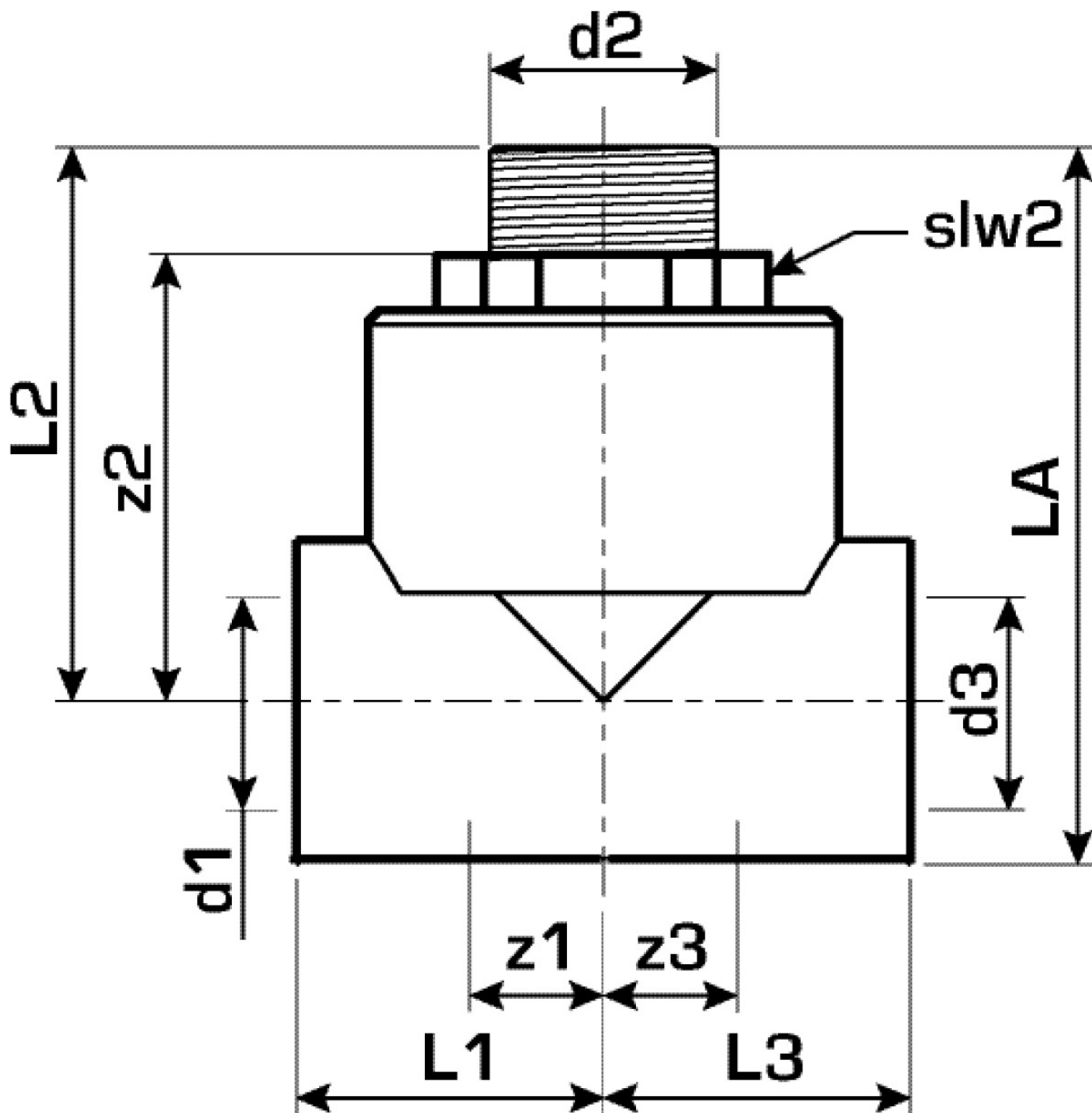

Art. No	label
55218DA2	20x1/2"BF