

WZ150 KELIT aluminium peeler 75

2814750

Areas of application

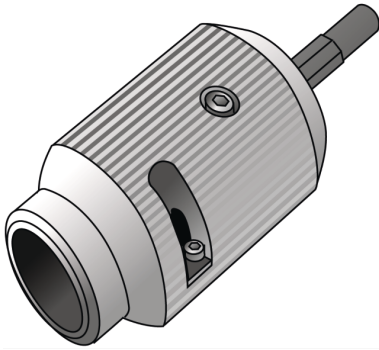

For peeling KELIT aluminium pipes in the welding area; when using E-welding sockets, you **MUST** extend the stop by unscrewing the Allen screw on the peeler. Alternatively, you can use a slow-running drill or cordless screw driver at a maximum speed of 500 rpm.

Specifications

| Product information | |
|---------------------|------------------------|
| VPE1 | 1 SA1 |
| weight | 1,156 KGM |
| text | KELIT aluminium peeler |
| INTRNR | 84663000 |
| main material group | TOOLS |
| material group | KELEN, KETRIX tools |
| code | WZ150 |

| Art. No | label |
|---------|-------|
| 2814750 | 75 |