

# KELOX<sub>FB</sub>

## KMP552 ?KELOX-PROTEC quick-push coupling

73175D00

### Areas of application

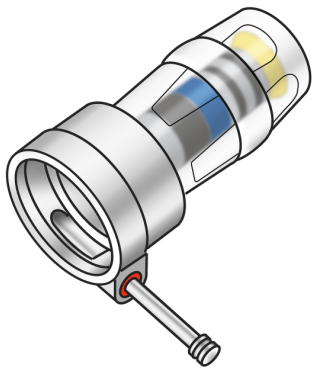

?Quick-push coupling, made of non-porous metal-plated brass, fits FB manifolds KMP590E, KMP590D and KMP590M, incl. support sleeves, O-rings, withdrawal barriers and a protector ring as an insertion locking device

### Approvals:



# Specifications

## Article information

port 1	Plug-in
port 2	Bayonet
execution	1-part
design	Straight

## Technical properties

insertion depth 1 (es1)	32.5
maximum working pressure at 20 ° C	10
PN	PN 10

## Product information

text	?KELOX-PROTEC quick-push coupling
code	KMP552

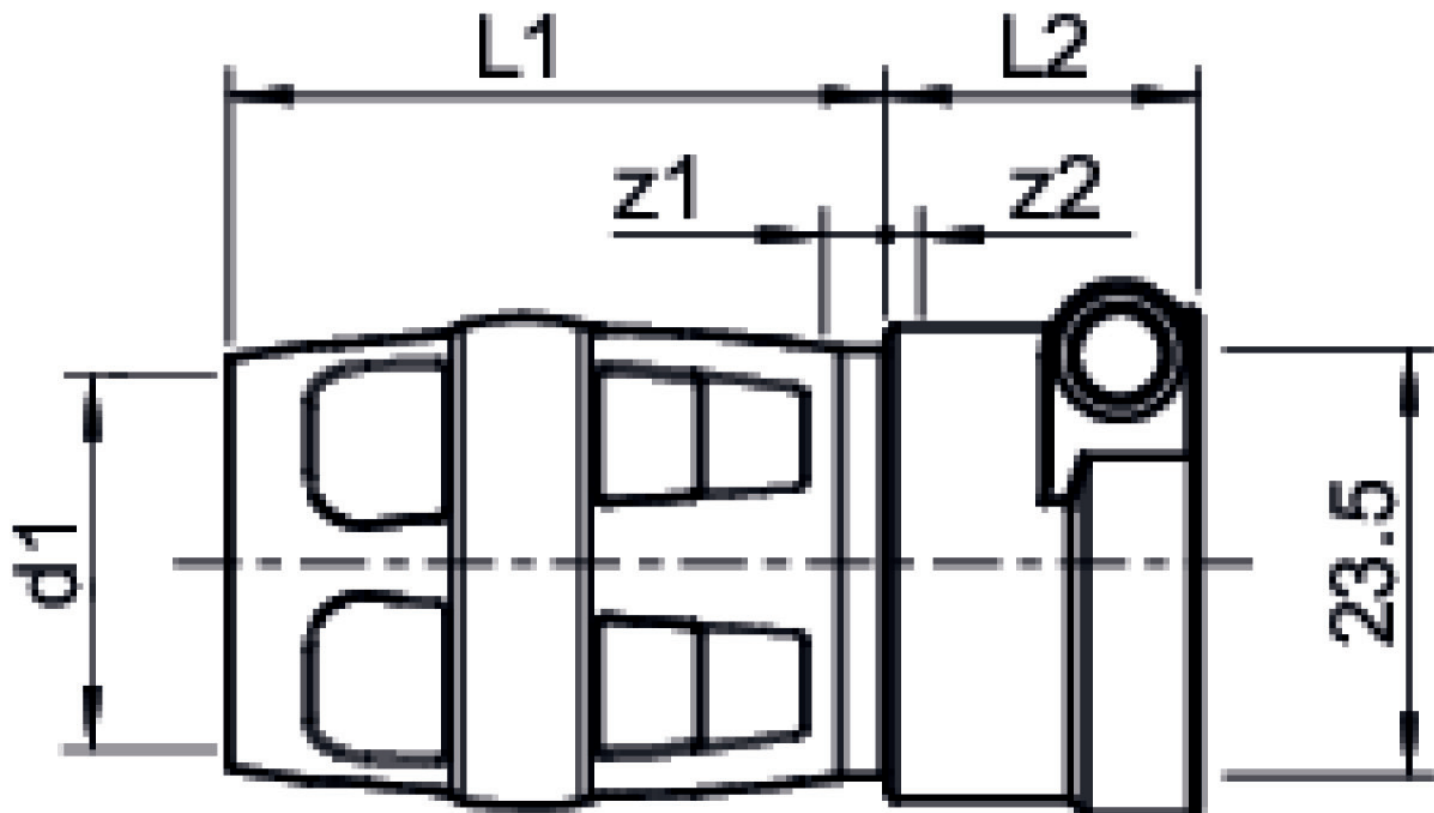

Art. No	d2	L1	L2	z1	z2	insertion depth 1 (es1)	Insertion depth 2 (es2)
73175D00	23.5	36	17	3.5	2	32.5	15