

KELEN

KE10 KELEN PP-RCT socket 20

2521501

Areas of application



KELEN PP-RCT Polyfusion welding fitting for connecting pipes with fittings made of the same material (no reduction of internal diameter)

Approvals:



Specifications

Article information

| | |
|-----------|------------------------|
| port 1 | Kunststoffschweißmuffe |
| port 2 | Kunststoffschweißmuffe |
| execution | 1-part |
| design | gerade |

Product information

| | |
|---------------------|------------------------|
| VPE1 | 10,00 SA1 |
| VPE2 | 200,00 KT1 |
| VPE3 | 1200,00 KT2 |
| VPE4 | 19200,00 PAL |
| weight | 0,012 KGM |
| text | KELEN PP-RCT socket |
| INTRNR | 39174000 |
| main material group | KELEN |
| material group | KELEN plastic fittings |
| code | KE10 |

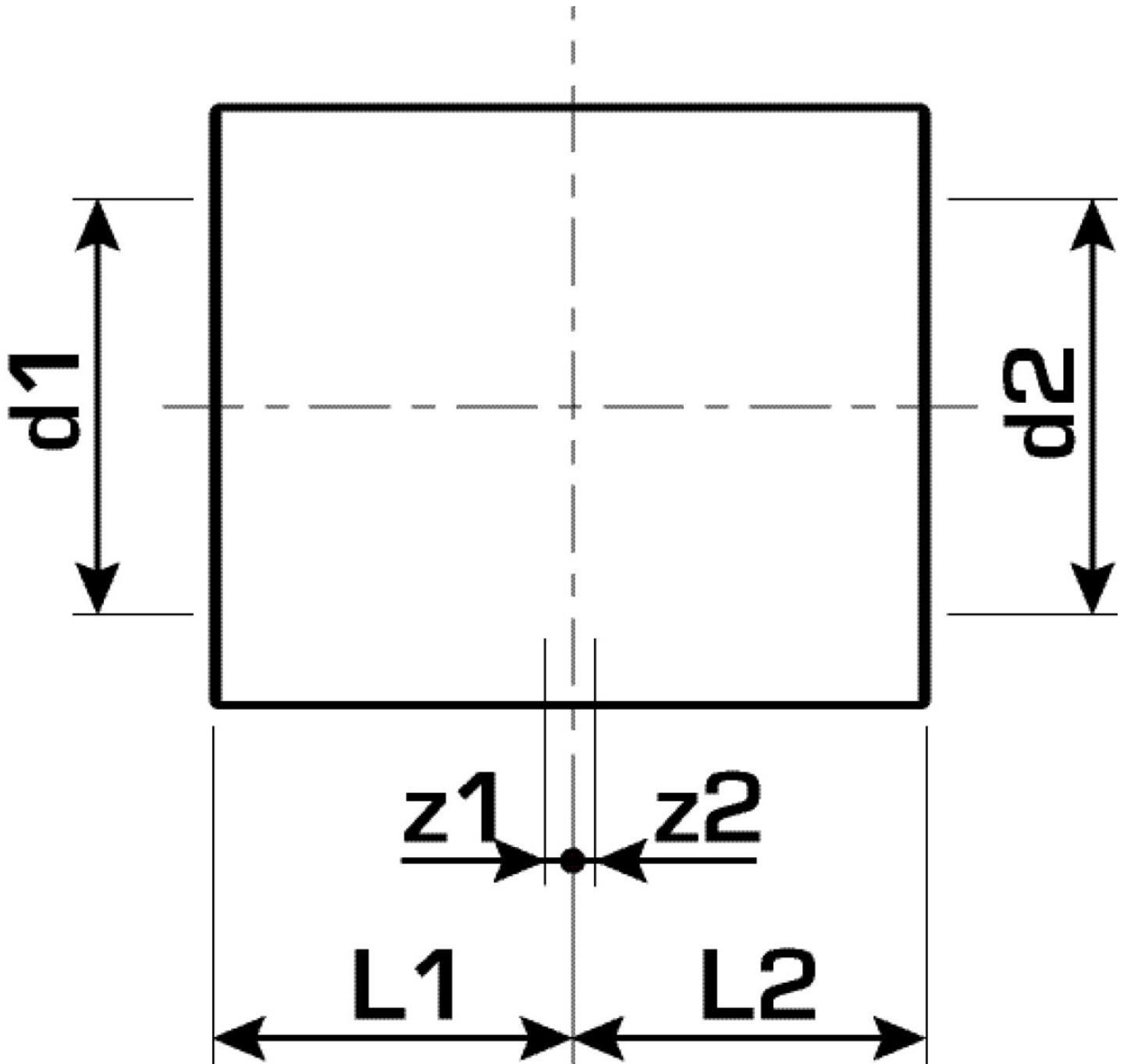

| Art. No | label | d1 mm | d2 mm | L1 mm | L2 mm | z1 mm | z2 mm |
|---------|-------|-------|-------|-------|-------|-------|-------|
| 2521501 | 20 | 20 | 20 | 16,5 | 16,5 | 1,5 | 1,5 |