

# STEEL FIX C-STAHL

## CP415 C-Steel press-repair coupling 54

54605HH0

### Areas of application

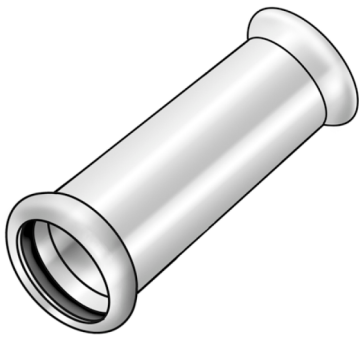

Press-fit repair coupling straight made of carbon steel coated with a zinc layer, incl. EPDM sealing components, d15-54 "leak before pressed"

Press contour: M

# Specifications

## Article information

port 1	Pressmuffe
port 2	Pressmuffe
execution	1-teilig
design	gerade
press contour	M

## Technical properties

insertion depth 1 (es1)	40 mm
maximum working pressure at 20 ° C	16 bar

## Product information

VPE1	2 SA1
VPE2	8 KT1
VPE3	200 DDP
weight	0,368 KGM
text	C-Steel press-repair coupling
INTRNR	73079980
main material group	STEELFIX
material group	C-STAHL pressfittings
code	CP415

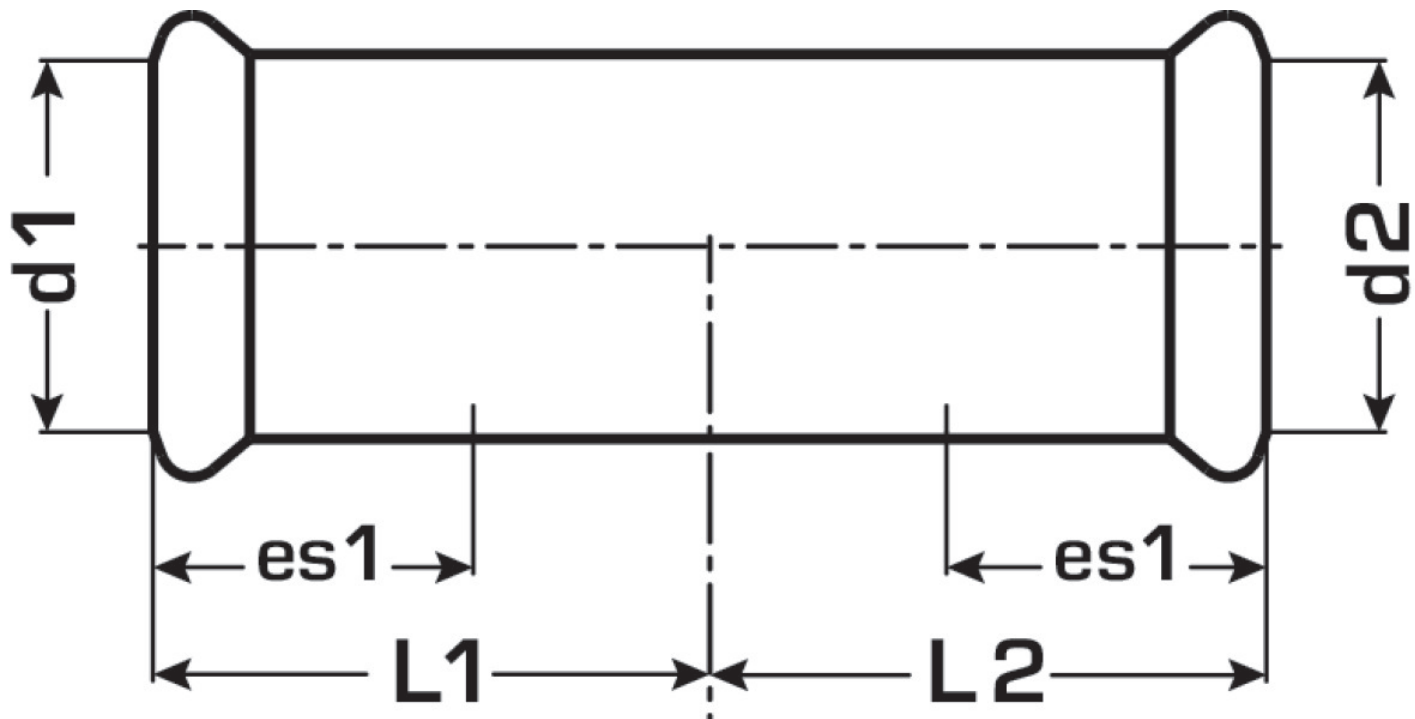

Art. No	label	d1 mm	d2 mm	L1 mm	L2 mm	insertion depth 1 (es1) mm	Insertion depth 2 (es2) mm
54605HH0	54	54	54	70	70	40	40