

STEEL FIX C-STAHl

CP415 C-Steel press-repair coupling 76,1

54605JJ0

Areas of application

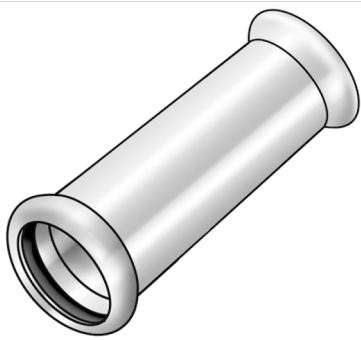

Press-fit repair coupling straight made of carbon steel coated with a zinc layer, incl. EPDM sealing components, d15-54 "leak before pressed"

Press contour: M

Specifications

Article information

port 1	Pressmuffe
port 2	Pressmuffe
execution	1-teilig
design	gerade
press contour	M

Technical properties

insertion depth 1 (es1)	60 mm
maximum working pressure at 20 ° C	16 bar

Product information

VPE1	2 SA1
weight	1,002 KGM
text	C-Steel press-repair coupling
INTRNR	73079980
main material group	STEELFIX
material group	C-STAHL pressfittings
code	CP415

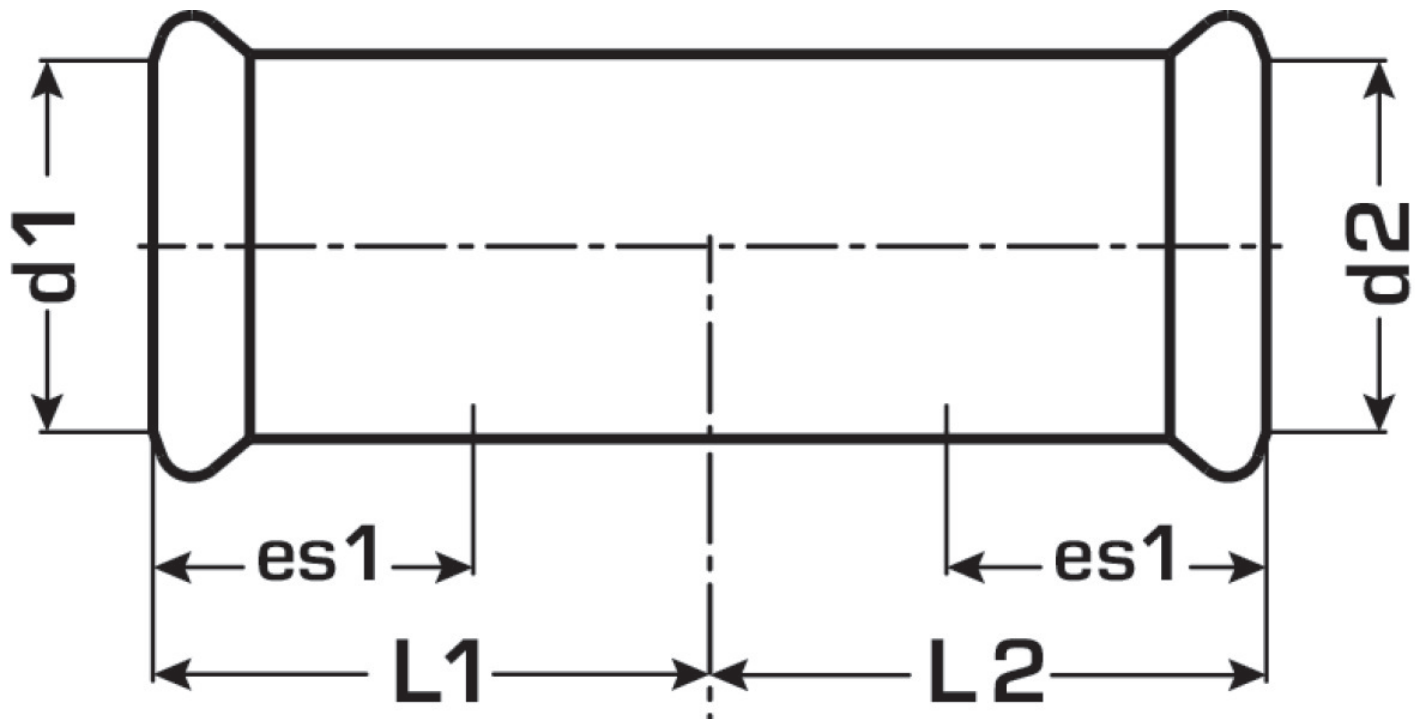

Art. No	label	d1 mm	d2 mm	L1 mm	L2 mm	insertion depth 1 (es1) mm	Insertion depth 2 (es2) mm
54605JJ0	76,1	76.1	76.1	115	115	60	60