

# KETRIX

## TRI27 KETRIX 45° elbow, male/female 25

55107EE0

### Areas of application

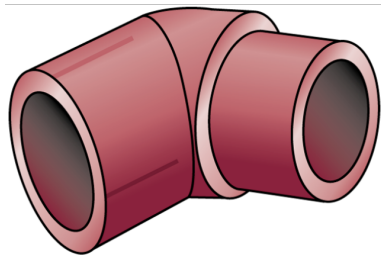

KETRIX polyfusion weld fitting for connecting POB pipes to fittings made of the same material without narrowing the cross section

# Specifications

## Article information

port 1	Plastic welding socket
port 2	Plastic welding end
execution	1-part
design	Elbow
angle	45 °

## Product information

VPE1	10,00 SA1
VPE2	120,00 KT1
VPE3	720,00 KT2
VPE4	11520,00 PAL
weight	0,028 KGM
text	KETRIX 45° elbow, male/female
INTRNR	39174000
main material group	KETRIX
material group	KETRIX plastic fittings
code	TRI27

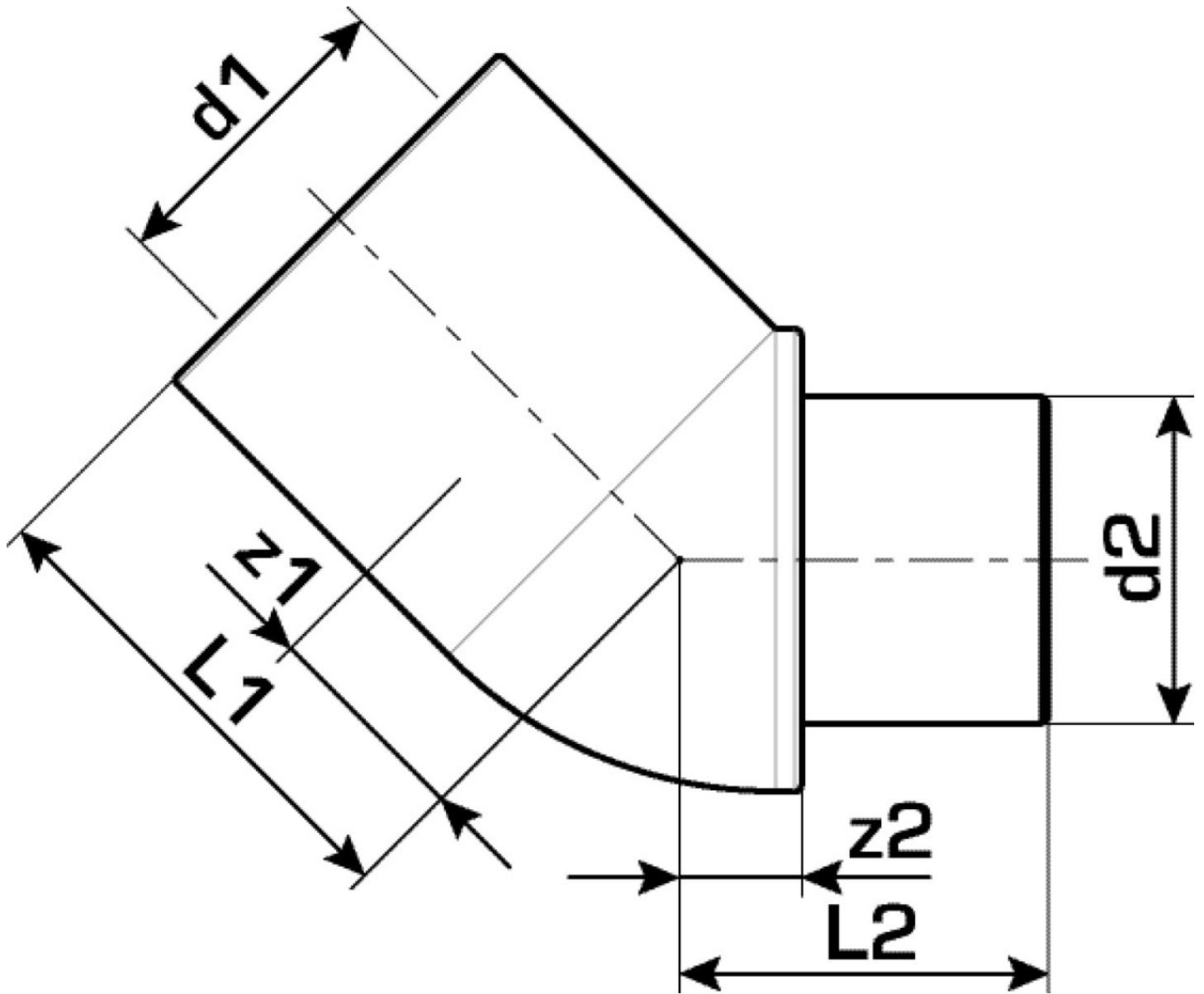

Art. No	label	d2 Inches	d1 mm	d2 mm	L1 mm	L2 mm	z1 mm	z2 mm
55107EE0	25	1/2" (15)	25	25	33	27	12	7