

KETRIX

TRI33 KETRIX tee with female thread branch 25x1/2"

55220E02

Areas of application

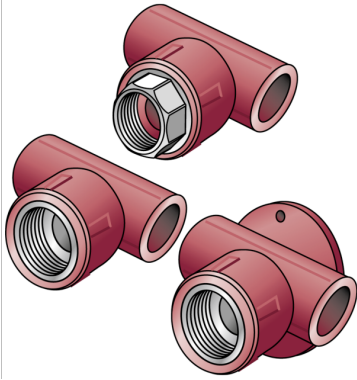

KETRIX polyfusion weld fitting for connecting POB pipes with fittings made of the same material without narrowing the cross-section, with injected male thread made of dezincification-resistant brass and non-porous metal-plating, thread conforms to ÖNORM EN 10226

System parts marked with an "S" are produced with a wrench attachment connection

Do NOT connect to threaded pipes or to cast iron fittings!

Specifications

Technical properties

maximum working pressure at 20 ° C 16 bar

Product information

VPE1	10,00 SA1
VPE2	50,00 KT1
VPE3	200,00 KT2
VPE4	4800,00 PAL
weight	0,153 KGM
text	KETRIX tee with female thread branch
INTRNR	39174000
main material group	KETRIX
material group	KETRIX metal fittings
code	TRI33

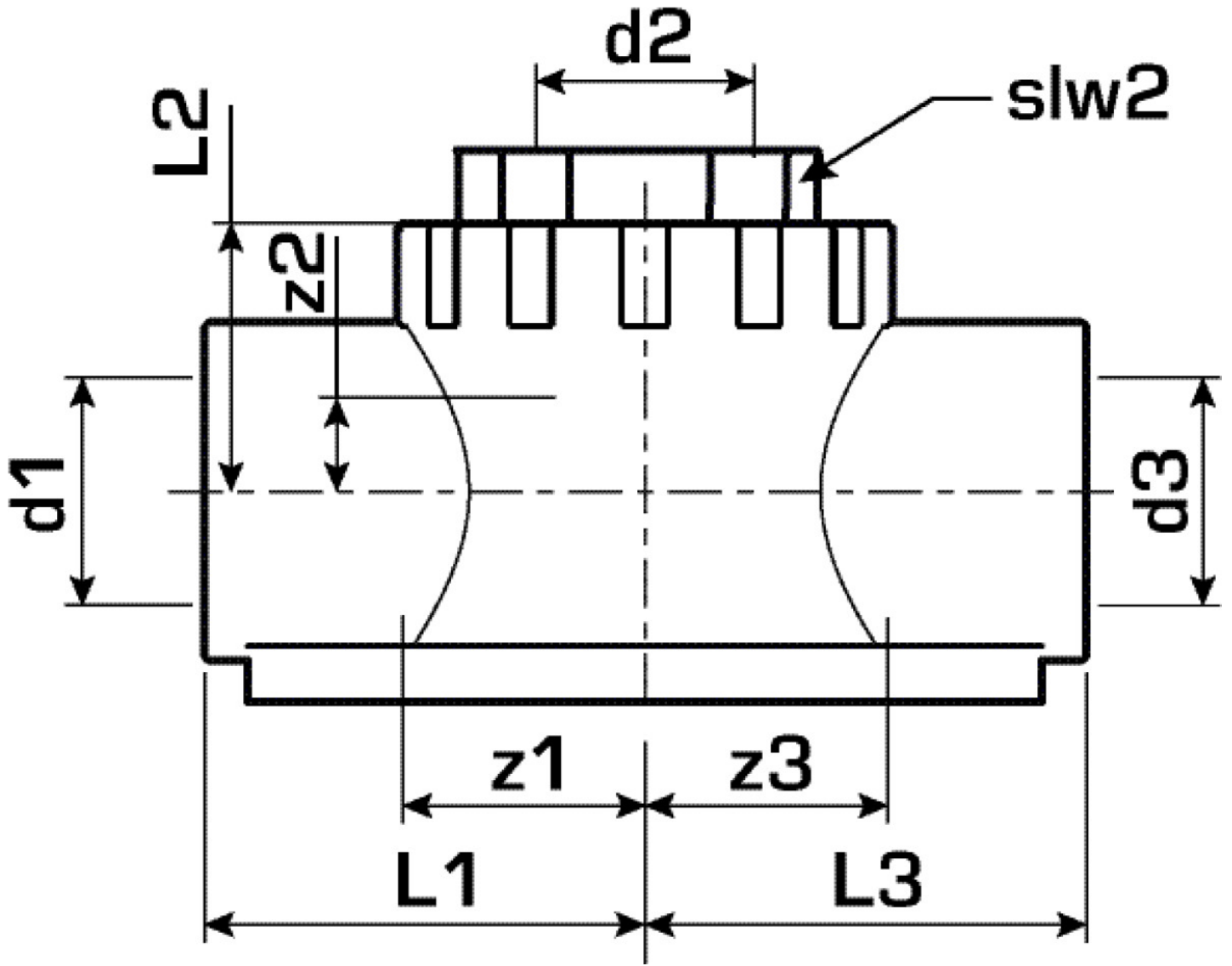

Art. No	label
55220E02	25x1/2"