

# KE30ST KELEN equal tee - PN10 125

2566001

## Areas of application

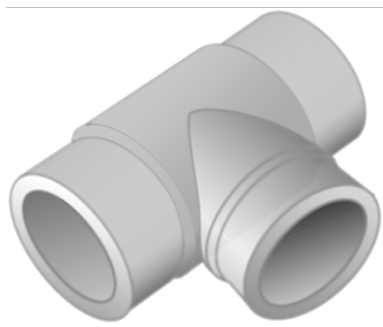

KELEN butt welding fitting for connecting pipes to fittings made of the same material

## Approvals:



# Specifications

## Article information

port 1	Kunststoffschweißende
port 2	Kunststoffschweißende
port 3	Kunststoffschweißende
execution	T-Stück
angle	90 °

## Technical properties

maximum working pressure at 20 ° C	10 bar
------------------------------------	--------

## Product information

VPE1	1,00 SA1
weight	1,700 KGM
text	KELEN equal tee - PN10
INTRNR	39174000
main material group	KELEN
material group	KELEN plastic fittings
code	KE30ST

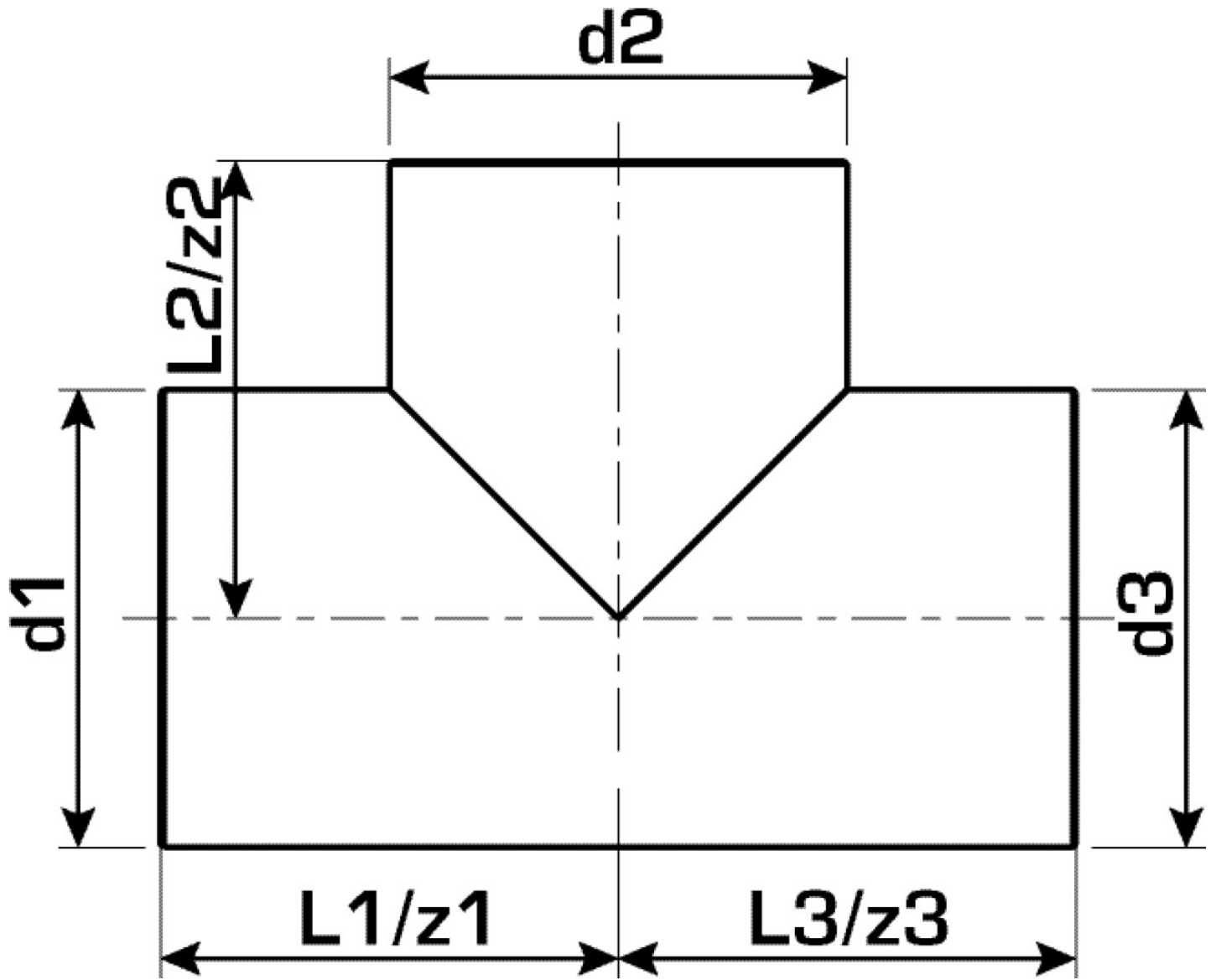

Art. No	label	d1 mm	d2 mm	d3 mm	L1 mm	L2 mm	L3 mm	z1 mm	z2 mm	z3 mm
2566001	125	125	125	125	178	175	178	178	175	178