

STEEL FIX C-STAHl

CP416 C-Steel press-weld on pipe 54x57

54606HH0

Areas of application

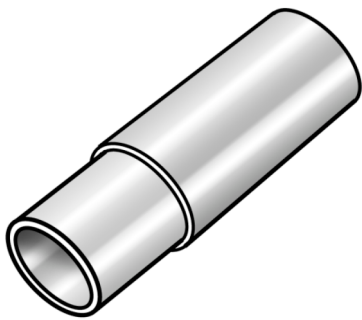

Weld-on pipe, straight, made of C-steel as an adaptor for steel pipes

ATTENTION, install corrosion-protection after welding!

Specifications

Article information

| | |
|---------------|------------------|
| port 1 | Zapfen/Rohrende |
| port 2 | Schweißanschluss |
| execution | 1-teilig |
| design | gerade |
| press contour | M |

Technical properties

| | |
|------------------------------------|--------|
| maximum working pressure at 20 ° C | 16 bar |
|------------------------------------|--------|

Product information

| | |
|---------------------|----------------------------|
| VPE1 | 4 SA1 |
| VPE2 | 8 KT1 |
| VPE3 | 200 DDP |
| weight | 0,453 KGM |
| text | C-Steel press-weld on pipe |
| INTRNR | 73079980 |
| main material group | STEELFIX |
| material group | C-STAHL pressfittings |
| code | CP416 |

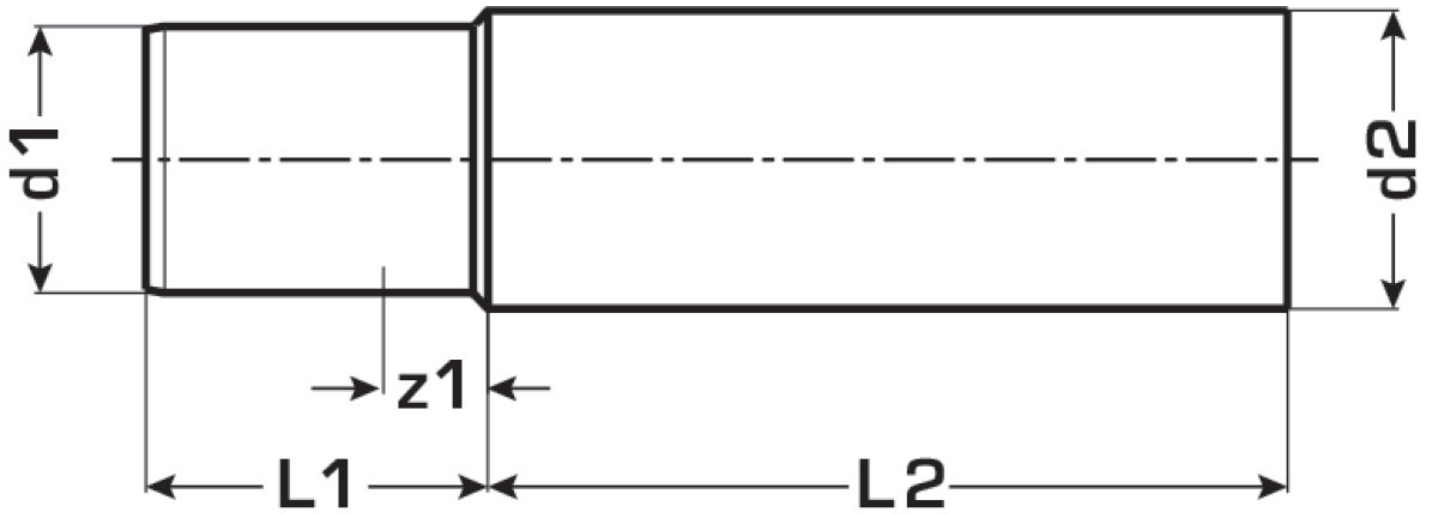

| Art. No | label | d1 mm | d2 mm | L1 mm | L2 mm | z1 mm |
|----------|-------|-------|-------|-------|-------|-------|
| 54606HH0 | 54x57 | 54 | 57 | 49 | 71 | 12 |