

KELOX

KMW467 KELOX-ULTRAX-W adapter elbow 90° with female thread 20x1/2"

71416D02

Areas of application

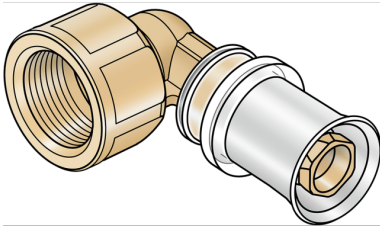

?Zeta value-optimised press-fit adapter elbow with female thread for sealing, made from dezincification-resistant (DZR) brass, including support sleeves with O-rings and stainless steel press-fit sleeves "leak before pressed", audible leakage signal at air-pressure testing
DO NOT screw in threaded pipes and cast iron fittings!

Approvals:



Specifications

Article information

port 1	Pressmuffe
port 2	Innengewinde zylindrisch (BSPP)
design	Winkel
angle	90 °
press contour	U

Technical properties

maximum working pressure at 20 ° C	16 bar
------------------------------------	--------

Product information

VPE1	10,00 SA1
VPE2	50,00 KT1
VPE3	3000,00 PAL
weight	0,091 KGM
text	KELOX-ULTRAX-W adapter elbow 90° with female thread
INTRNR	74122000
main material group	KELOX
code	KMW467

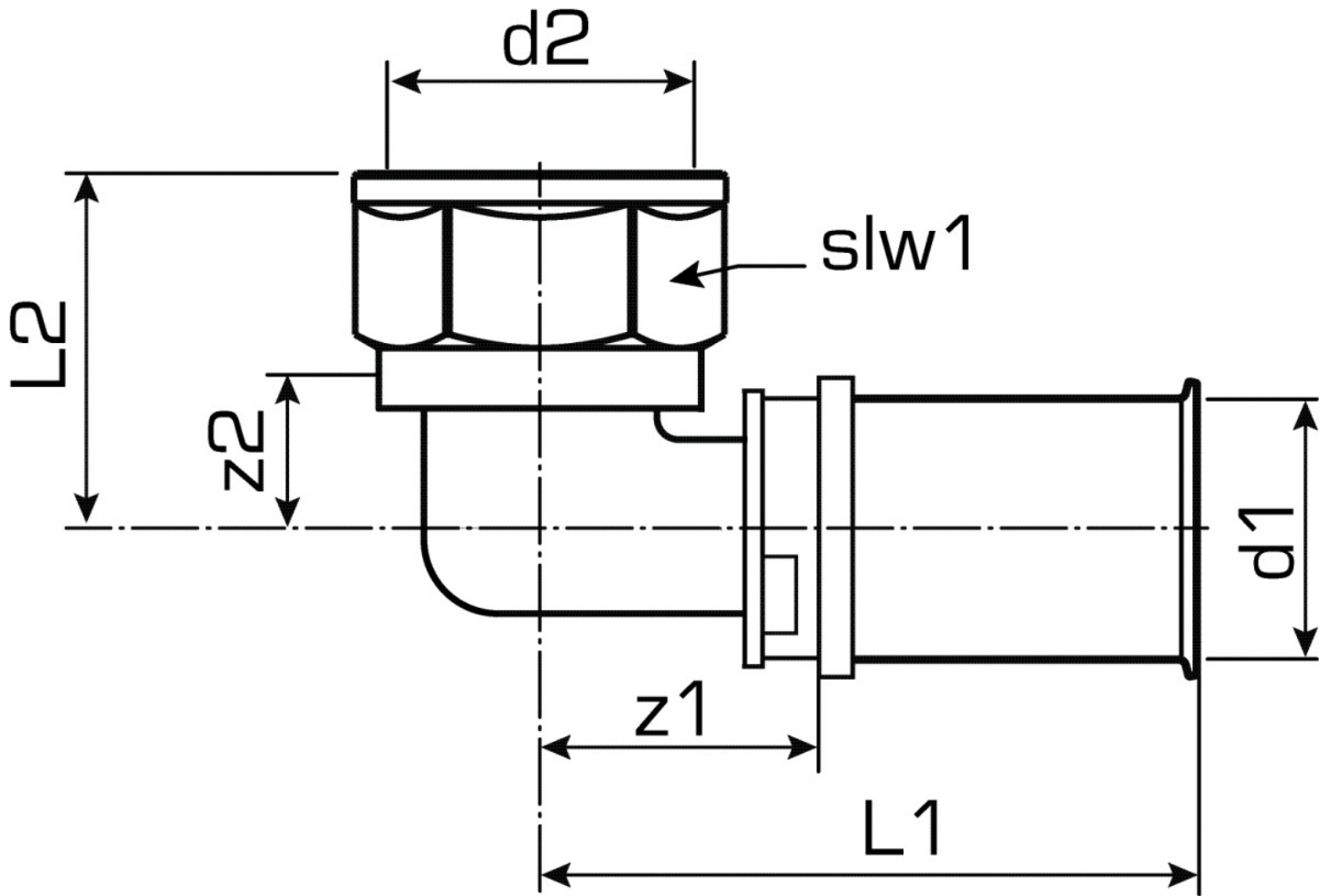

Art. No	label	d2	d1 mm	L1 mm	L2 mm	z1 mm	z2 mm	slw1 mm
71416D02	20x1/2"	1/2" (15)	20	48,5	28	22,5	17	27