

KELOX

KMW467 KELOX-ULTRAX-W adapter elbow 90° with female thread 25x1"

71416E05

Areas of application

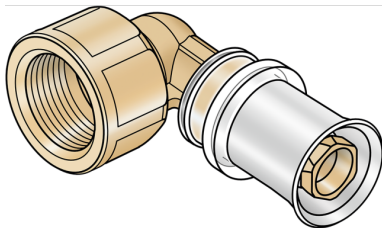

?Zeta value-optimised press-fit adapter elbow with female thread for sealing, made from dezincification-resistant (DZR) brass, including support sleeves with O-rings and stainless steel press-fit sleeves "leak before pressed", audible leakage signal at air-pressure testing
DO NOT screw in threaded pipes and cast iron fittings!

Approvals:



Specifications

Article information

| | |
|---------------|---------------------------------|
| port 1 | Pressmuffe |
| port 2 | Innengewinde zylindrisch (BSPP) |
| design | Winkel |
| angle | 90 ° |
| press contour | U |

Technical properties

| | |
|------------------------------------|--------|
| maximum working pressure at 20 ° C | 16 bar |
|------------------------------------|--------|

Product information

| | |
|---------------------|---|
| VPE1 | 5,00 SA1 |
| VPE2 | 30,00 KT1 |
| VPE3 | 2400,00 PAL |
| weight | 0,165 KGM |
| text | KELOX-ULTRAX-W adapter elbow 90° with female thread |
| INTRNR | 74122000 |
| main material group | KELOX |
| code | KMW467 |

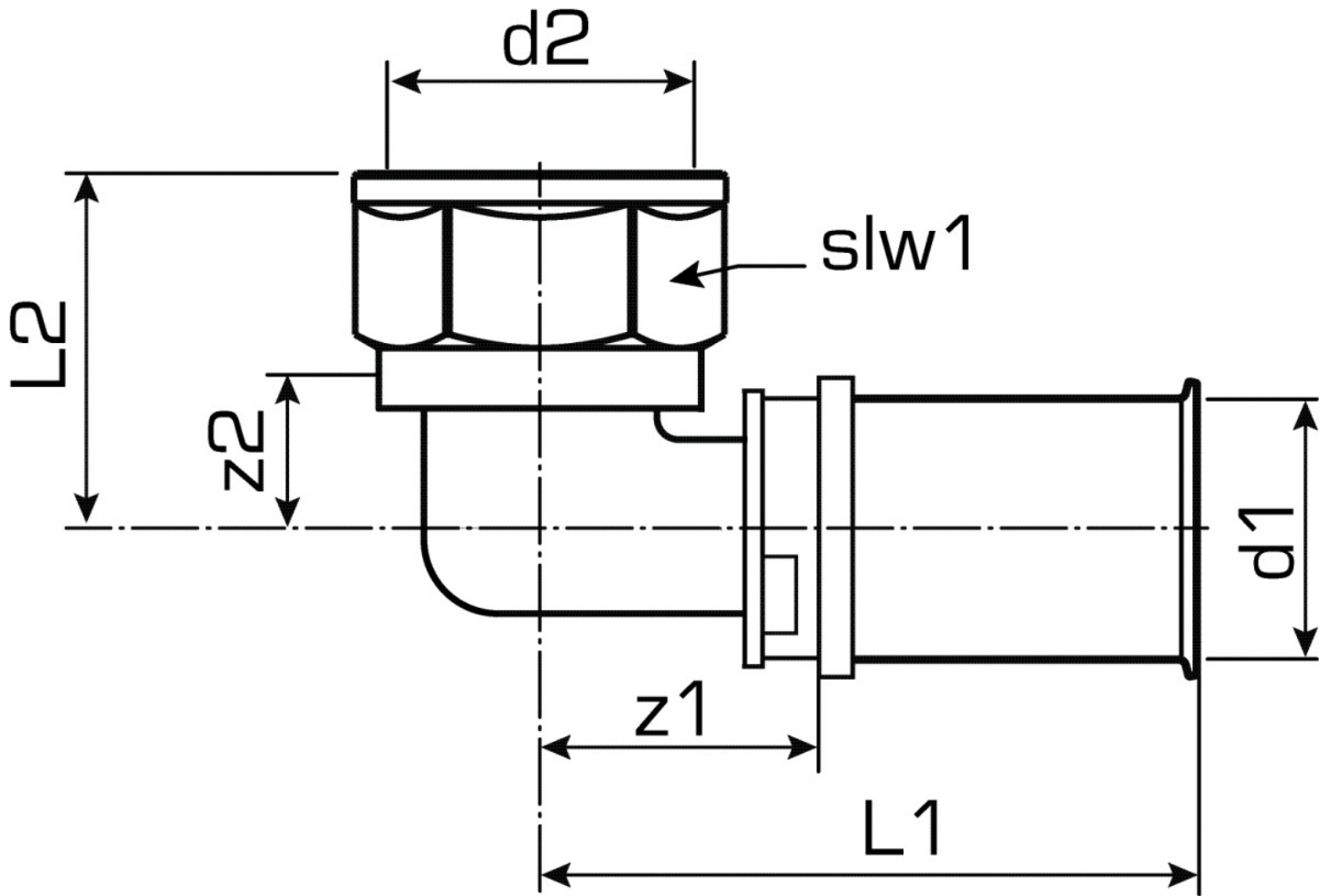

| Art. No | label | d2 | d1 mm | L1 mm | L2 mm | z1 mm | z2 mm | slw1 mm |
|----------|-------|----|-------|-------|-------|-------|-------|---------|
| 71416E05 | 25x1" | 1" | 25 | 61 | 34,5 | 31 | 22,5 | 41 |