

# KELOX

## KWW467 KELOX-WINDOWX-W adapter elbow 90° with female thread 20x1/2"

72416D02

### Areas of application

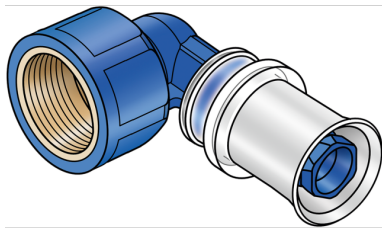

?Zeta value-optimised press-fit adapter bracket with female thread for sealing, made from PPSU, including support sleeves with O-rings and stainless steel press-fit sleeves "leak before pressed", audible leakage signal at air-pressure testing

DO NOT screw in threaded pipes and cast iron fittings!

DO NOT use liquid sealants!

## Approvals:



# Specifications

## Article information

port 1	Pressmuffe
port 2	Innengewinde zylindrisch BSPT-Rp (ISO 7-1 / EN 10226-1)
design	Winkel
angle	90 °
press contour	U

## Technical properties

maximum working pressure at 20 ° C	16 bar
------------------------------------	--------

## Product information

VPE1	10,00 SA1
VPE2	30,00 KT1
VPE3	2160,00 PAL
weight	0,038 KGM
text	KELOX-WINDOWX-W adapter elbow 90° with female thread
INTRNR	74122000
main material group	KELOX
code	KWW467

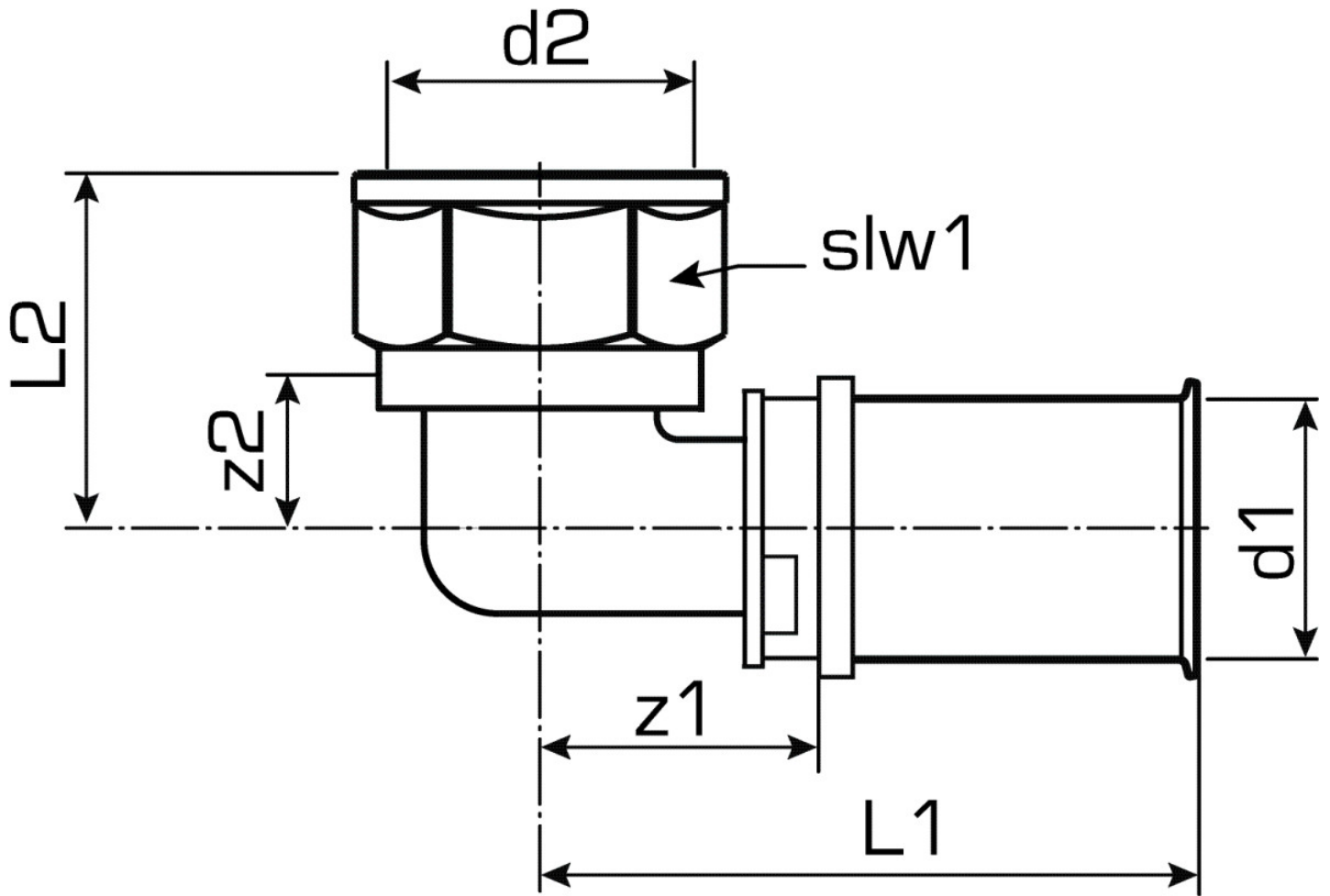

Art. No	label	d2	d1 mm	L1 mm	L2 mm	z1 mm	z2 mm
72416D02	20x1/2"	1/2" (15)	20	50	33	24	20