

KELOX

KWW467 KELOX-WINDOWX-W adapter elbow 90° with female thread 32x1"

72416F05

Areas of application

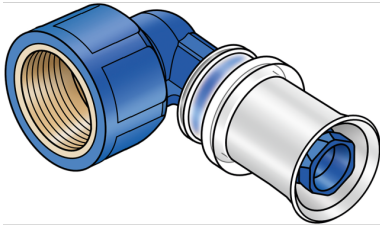

?Zeta value-optimised press-fit adapter bracket with female thread for sealing, made from PPSU, including support sleeves with O-rings and stainless steel press-fit sleeves "leak before pressed", audible leakage signal at air-pressure testing

DO NOT screw in threaded pipes and cast iron fittings!

DO NOT use liquid sealants!

Approvals:



Specifications

Article information

port 1	Pressmuffe
port 2	Innengewinde zylindrisch BSPT-Rp (ISO 7-1 / EN 10226-1)
design	Winkel
angle	90 °
press contour	U

Technical properties

maximum working pressure at 20 ° C	16 bar
------------------------------------	--------

Product information

VPE1	5,00 SA1
VPE2	15,00 KT1
VPE3	1080,00 PAL
weight	0,088 KGM
text	KELOX-WINDOWX-W adapter elbow 90° with female thread
INTRNR	74122000
main material group	KELOX
code	KWW467

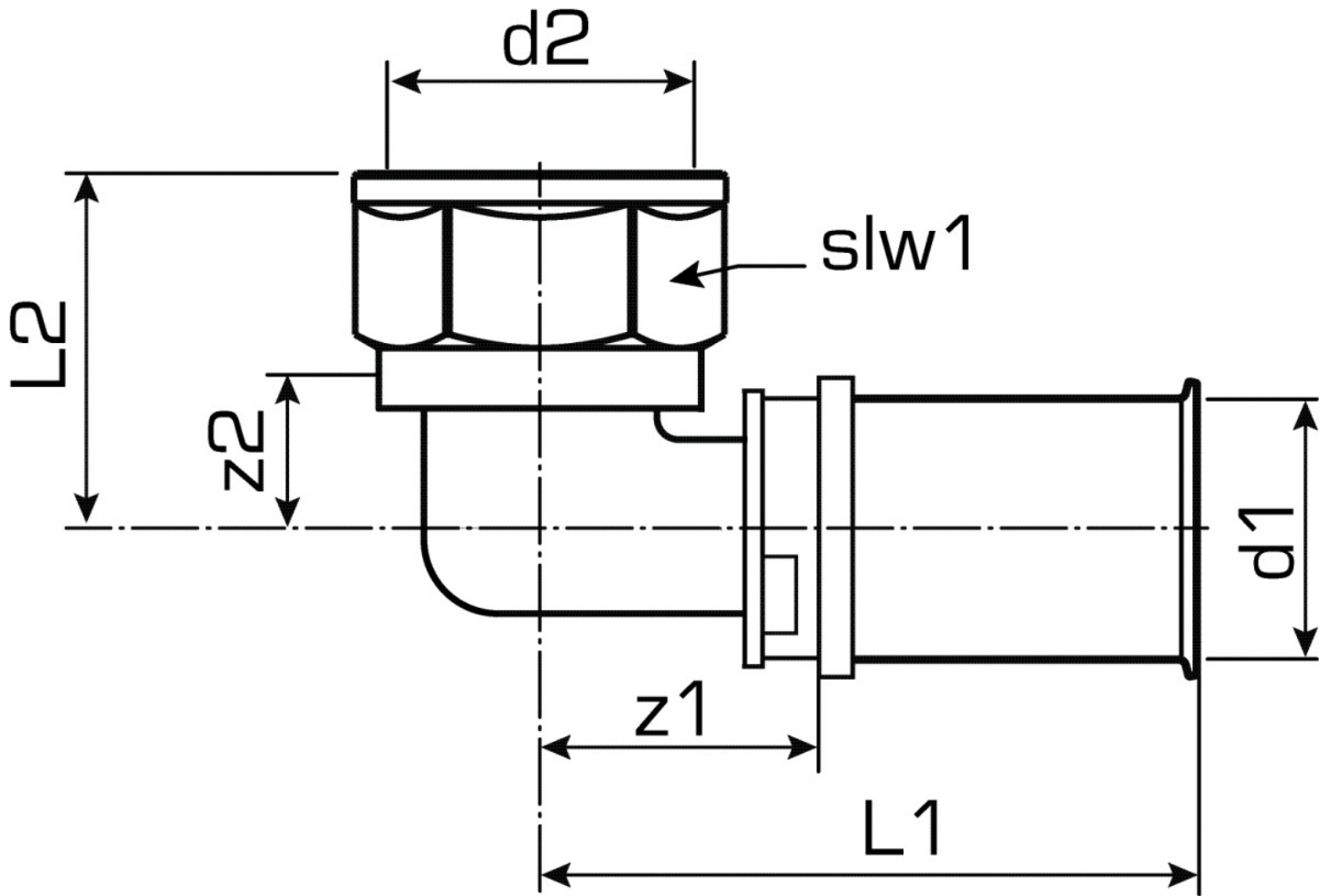

Art. No	label	d2	d1 mm	L1 mm	L2 mm	z1 mm	z2 mm
72416F05	32x1"	1"	32	62	45	32	28