

STEEL FIX C-STAHL

CP415 STEELFIX carbon steel press-fit repair coupling 76,1

54605JJ0

Areas of application

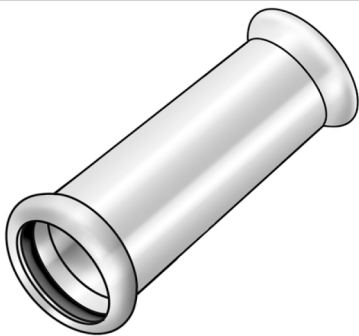

Press-fit repair coupling straight made of carbon steel coated with a zinc layer, incl. EPDM sealing elements, d15-54 "leak before pressed"

Press contour: M

Specifications

Article information

port 1	Pressmuffe
port 2	Pressmuffe
execution	1-part
design	gerade
press contour	M

Technical properties

insertion depth 1 (es1)	55 mm
maximum working pressure at 20 ° C	16 bar

Product information

VPE1	2,00 SA1
VPE2	20,00 KT1
weight	1,002 KGM
text	STEELFIX carbon steel press-fit repair coupling
INTRNR	73079980
main material group	STEELFIX
material group	C-STAHl pressfittings
code	CP415

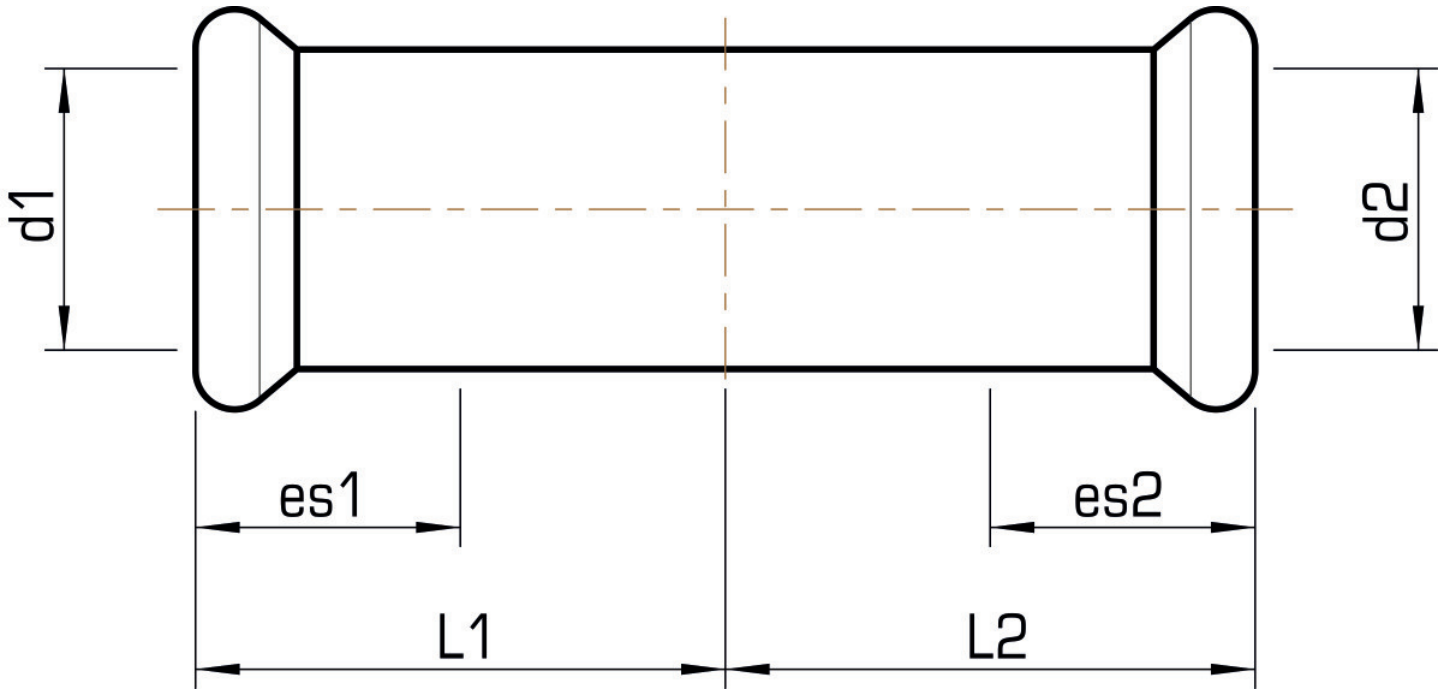

Art. No	label	d1 mm	d2 mm	L1 mm	L2 mm	insertion depth 1 (es1) mm	Insertion depth 2 (es2) mm
54605JJ0	76,1	76,1	76,1	115	115	55	55