

# STEEL FIX EDELSTAHL

NP410 STEELFIX stainless steel press-fit coupling 28

53600EE0

## Areas of application



Press coupling straight made of stainless steel 1.4404, incl. EPDM sealing elements, d15-54 "leak before pressed"

Press contour: M

## Approvals:



KE KELIT GmbH

A 4020 Linz, Ignaz-Mayer-Straße 17, Austria, Europe

PHONE +43 (0) 50 779 E-MAIL [office@kekelit.com](mailto:office@kekelit.com)

[www.kekelit.com](http://www.kekelit.com)

# Specifications

## Article information

|               |            |
|---------------|------------|
| port 1        | Pressmuffe |
| port 2        | Pressmuffe |
| execution     | 1-part     |
| design        | gerade     |
| press contour | M          |

## Product information

|                |   |
|----------------|---|
| VPE1           | 10,00 SA1                                   |
| VPE2           | 60,00 KT1                                   |
| VPE3           | 1500,00 DDP                                 |
| weight         | 0,075 KGM                                   |
| text           | STEELFIX stainless steel press-fit coupling |
| INTRNR         | 73072980                                    |
| material group | EDELSTAHL pressfittings                     |
| code           | NP410                                       |

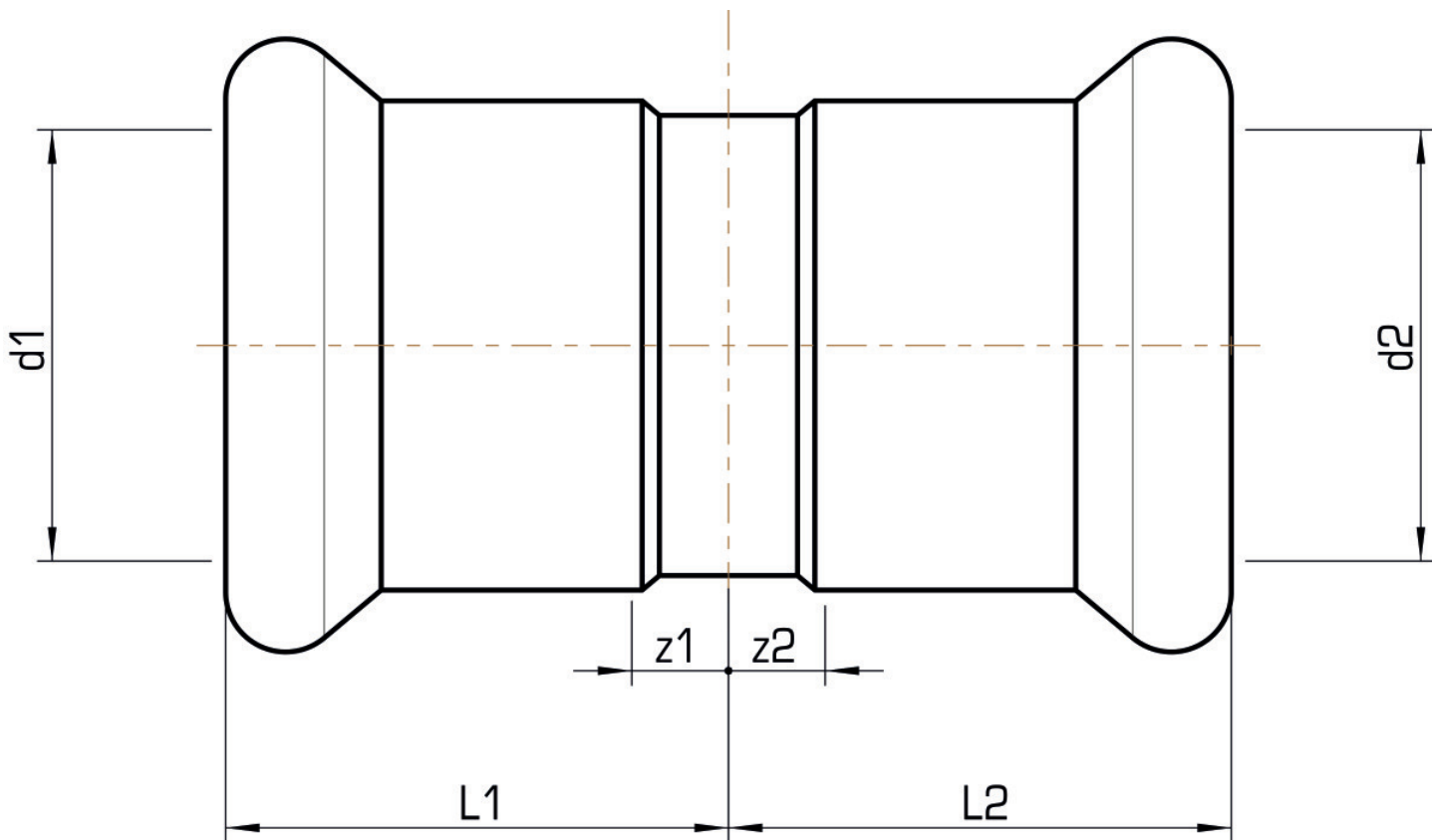

| Art. No  | label | d1 mm | d2 mm | L1 mm | L2 mm | z1 mm | z2 mm |
|----------|-------|-------|-------|-------|-------|-------|-------|
| 53600EE0 | 28    | 28    | 28    | 28    | 28    | 5     | 5     |