

STEEL FIX C-STAHL

CP416 C-Steel press-weld on pipe 35x38

54606FF0

Areas of application

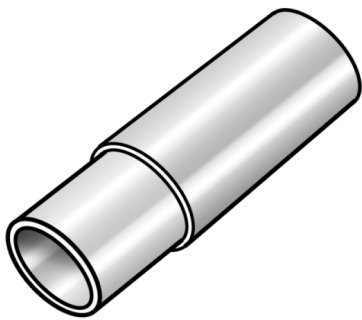

Weld-on pipe, straight, made of C-steel as an adaptor for steel pipes

ATTENTION, install corrosion-protection after welding!

Specifications

Article information

port 1	Zapfen/Rohrende
port 2	Schweißanschluss
execution	1-teilig
design	gerade
press contour	M

Technical properties

maximum working pressure at 20 ° C	16 bar
------------------------------------	--------

Product information

VPE1	10 SA1
VPE2	30 KT1
VPE3	750 DDP
weight	0,269 KGM
text	C-Steel press-weld on pipe
INTRNR	73079980
main material group	STEELFIX
material group	C-STAHL pressfittings
code	CP416

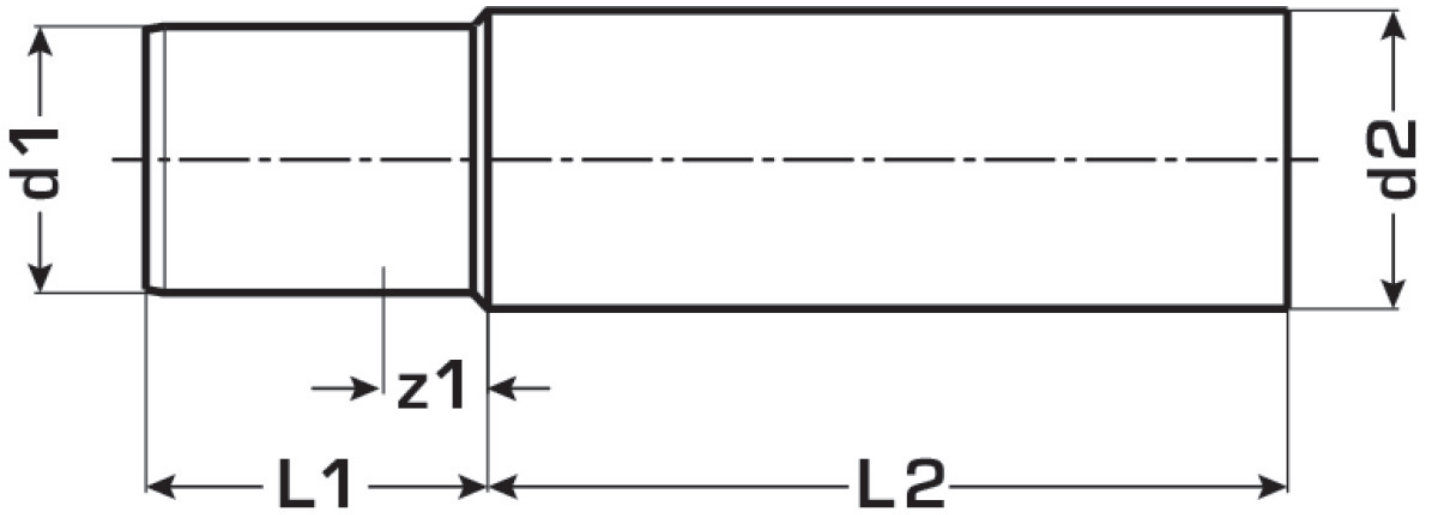

Art. No	label	d1 mm	d2 mm	L1 mm	L2 mm	z1 mm
54606FF0	35x38	35	38	35	85	12