

KETRIX

TRI33 KETRIX tee with female thread branch 32x1"S

55220F05

Areas of application

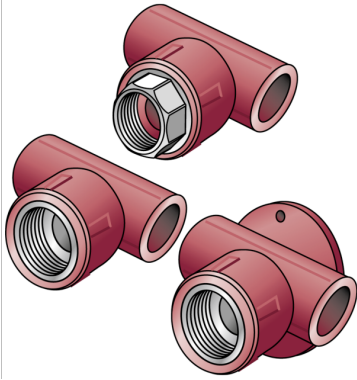

KETRIX polyfusion weld fitting for connecting POB pipes with fittings made of the same material without narrowing the cross-section, with injected male thread made of dezincification-resistant brass and non-porous metal-plating, thread conforms to ÖNORM EN 10226

System parts marked with an "S" are produced with a wrench attachment connection

Do NOT connect to threaded pipes or to cast iron fittings!

Specifications

Technical properties

maximum working pressure at 20 ° C 16 bar

Product information

VPE1 5,00 SA1

VPE2 20,00 KT1

VPE3 80,00 KT2

VPE4 1920,00 PAL

weight 0,241 KGM

text KETRIX tee with female thread branch

INTRNR 39174000

main material group KETRIX

material group KETRIX metal fittings

code TRI33

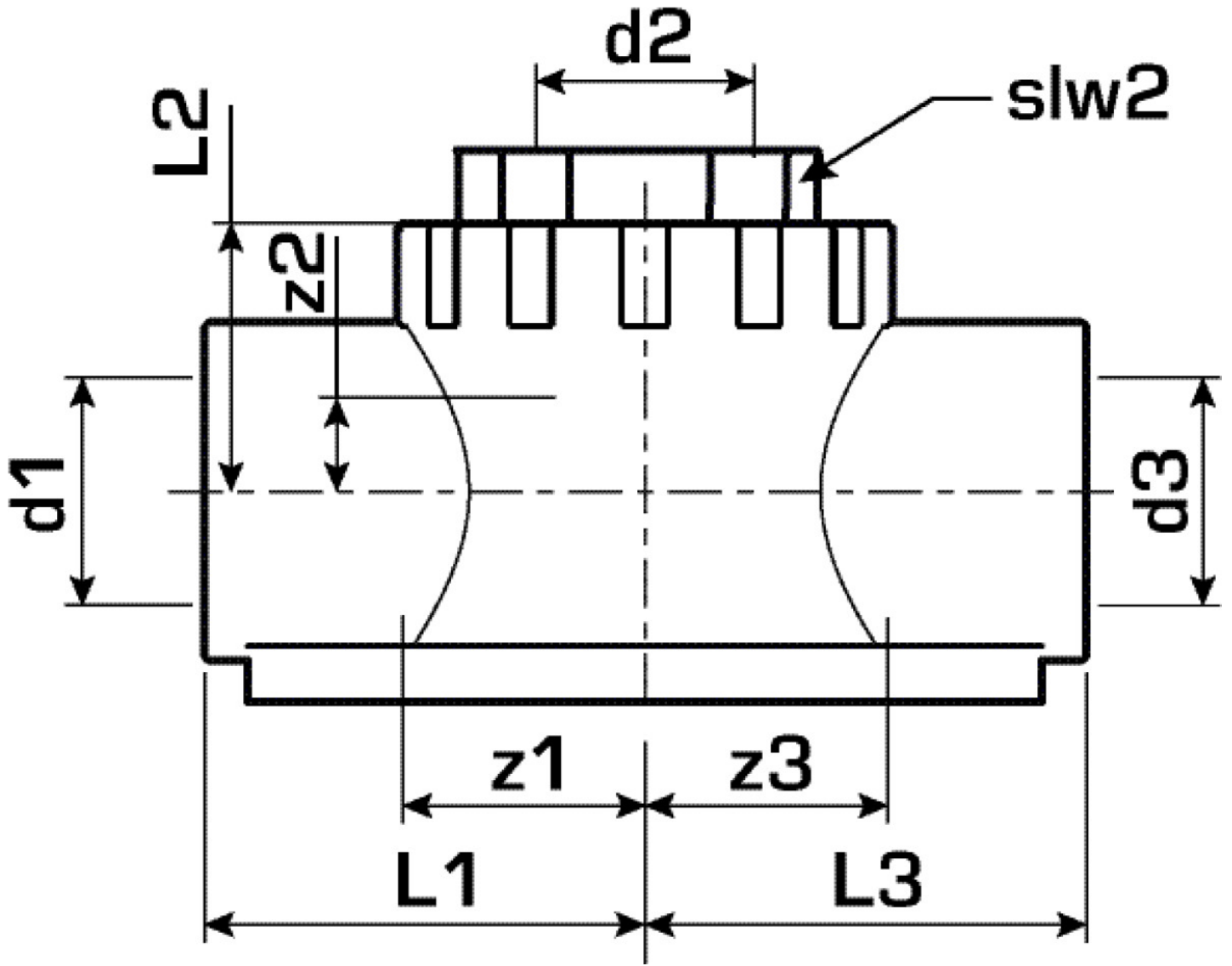

Art. No	label
55220F05	32x1"S