

KETRON

KET750 KETRON drinking fountain floor flange D 240mm

21807500

Areas of application

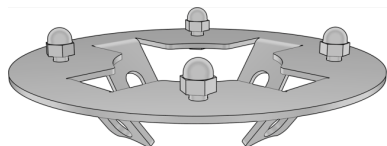

Bottom flange made of V4A stainless steel with tabs for concreting. With fastening bolts and cap nuts. For fastening KETRON drinking fountains. Insertion diameter 95 mm. (ATTENTION: Pay attention to hole circle positioning for drinking fountains!)

Specifications

Product information	
VPE1	1,00 KT1
weight	1,500 KGM
text	KETRON drinking fountain floor flange
INTRNR	73089098
code	KET750

Art. No	label
21807500	D 240mm